

061CS; 4WAY DIVERTER BODY

BASIC INSTALLATION REQUIREMENTS



All installation of products and systems must be in accordance with the applicable SANS and NHBC regulations and specifications.

- Always ensure the ½" BSP female connection end to supply the shower is facing upwards as the directional arrow indicates;
- Always ensure the 1 x ¾" BSP female connection end to supply the bath is facing downwards as the directional arrow indicates;
- Always ensure to install the hot water supply to the left hand side of the product (as you face the product) and the cold water supply to the right hand side (as you face the product) of which both connection ends are ¾" BSP female;

Balanced pressure

- Hot and Cold water pressure must be balanced (equal pressure) to all mixers, mixing points, showers and hand showers. This is achieved by taking the cold water supply from the low pressure side of the pressure valve.

General requirements

- All pipes must be flushed clean before putting the system into operation;
- Waterflow must be in the direction of the arrow marked on the valve body;
- Supply pipes adequately sized

Side view of product

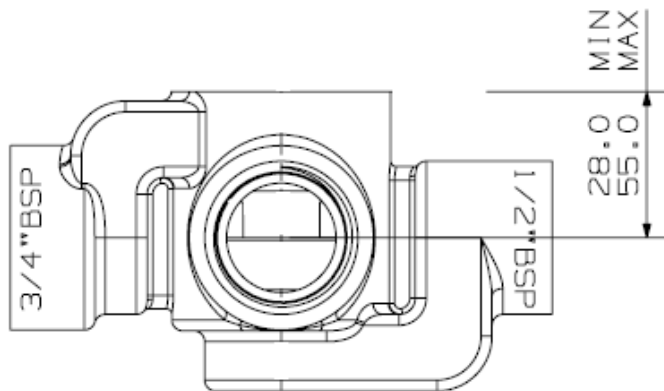

Warranty statement

All cobra products are backed by a guarantee against defective materials and workmanship during the manufacturing process.

Our products are backed by a Service Department and, most importantly, a full range of replacement parts are available from plumber's merchants.

The same commitment that goes into designing and manufacturing a quality product also goes into ensuring the quality of the service back-up at every stage of design and installation.

The warrantee will be applicable for a period of 2 years.