

206-20

Bib tap

Hot & cold indices included. 3/4" BSP male inlet

[SANS 226 TYPE2](#)



Includes

- * Bib tap

Specific features and benefits

- * 1/2" heavy pattern low resistance for low pressure or high water demand installations
- * Chrome plated

Spare parts

- * Head part complete **P-5**
- * 1/2" heavy pattern tap washer **C-097-15**



WEIGHT

531gr

LINE DRAWING

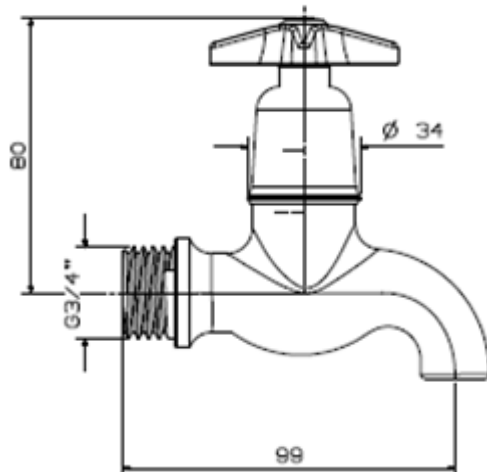

FLOW RATES

Notes -

The R&D test facility was tested with various static pressures. The following flow readings were taken.

- 1) With a Ø22mm x 1 meter long class "0" pipe with open end
- 2) With a Ø15mm x 1 meter long class "0" pipe with open end

Static Pressure	22mm Pipe	15mm Pipe		Static Pressure	22mm Pipe	15mm Pipe
10 kPa	15 l/min	13 l/min		150 kPa	68 l/min	54 l/min
20 kPa	24 l/min	22 l/min		200 kPa	79 l/min	64 l/min
30 kPa	27 l/min	26 l/min		250 kPa	90 l/min	70.5 l/min
40 kPa	33 l/min	29 l/min		300 kPa	98 l/min	79.5 l/min
50 kPa	38 l/min	32.5 l/min		350 kPa	105 l/min	83.5 l/min
100 kPa	55 l/min	45 l/min		400 kPa	115 l/min	89.5 l/min

