

503-21B

### Pillar type tap

Elbow action. 1/4-turn ceramic disc. Blue indice. 1/2" BSP male inlet

#### [SANS 226 TYPE 2](#)



#### Includes

- \* Pillar tap
- \* Flanged backnut

#### Specific Features and Benefits

- \* 1/4-turn ceramic disk headpart (*Clockwise closing*)
- \* Chrome plated

#### Spare parts

- \* Blue headpart complete **S-21-CLOCK**
- \* Blue headpart only **S-21-1CLOCK**
- \* Connection backnut **088-15**



### Weight

770gr

### Line drawing

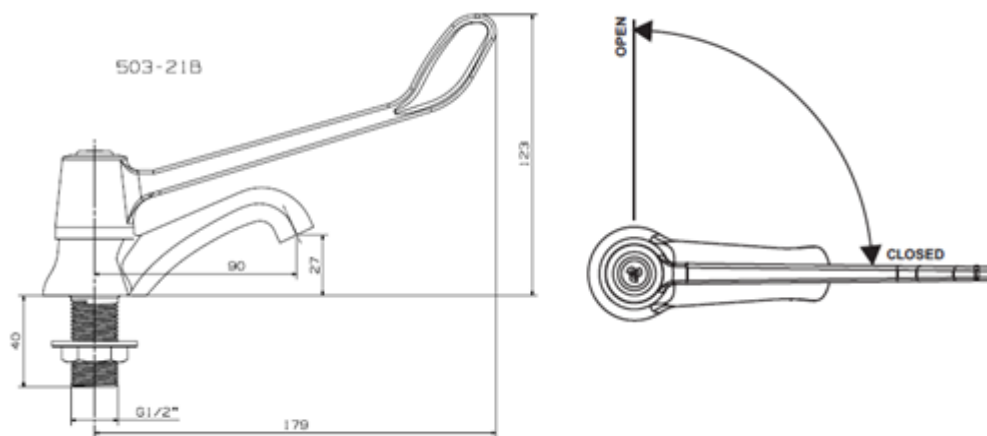

## **SANS specifications**

SANS226, Type 2 (\*\* specific extracts from the applicable SANS specifications and regulations to which such products will have to adhere to, to bear the SABS approved mark)

Design:

The type 2 tap shall be designed to operate on a static water supply pressure of 2,000kPa;  
It shall furthermore be designed to ensure that at a dynamic supply pressure of 50kPa, the flow rate of the tap shall not be less than –

**Table 1 — Flow rates for taps**

1	2	3	4	5
Class of tap	Dynamic supply pressure kPa	Nominal size mm		
		15	20	25
		Flow rate L/m		
1	10 <sup>+1</sup> <sub>0</sub>	9	15	23
2	50 <sup>+5</sup> <sub>0</sub>	9	18	25