

designer collection



Designed by

brian steinhobel



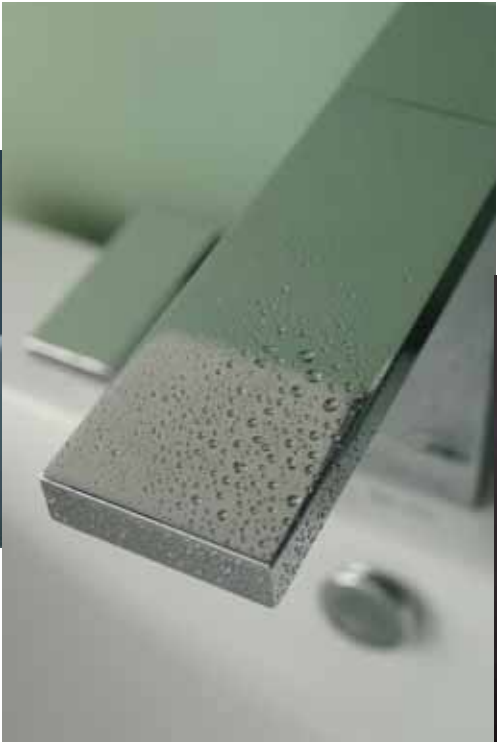

contents

The finest in design <i>The Brian Steinhobel Designer Range</i>	pg. 5
Callisto <i>Product description</i> <i>Specifications</i>	pg. 6
Leading Edge <i>Product description</i> <i>Specifications</i>	pg. 10
Tapno <i>Product description</i> <i>Specifications</i>	pg. 14



About Brian Steinhobel

Brian Steinhobel's reputation, as an exceptional and award-winning industrial designer, is the result of many years invested in the design of sports equipment, appliances, furniture, automotive and aeronautical items. Brian's extensive list of highly satisfied clients includes the Arrows Formula One Team, BMW, Coca-Cola, Colgate, Daimler Chrysler, Elna, Lever Ponds, Nissan, Shell, Siemens, Smith Kline Beecham, Virgin and Zodiac... and now Cobra.

Designed by

brian **Steinhobel**



the finest in design



The world's finest in design
The Brian Steinhobel Designer Range

The Designer Collection of taps and mixers from Cobra is exquisitely elegant in form and function, design and detail. From the contemporary classical Callisto to luxurious Leading Edge and trendsetting Tapno, these ranges have been crafted exclusively with infinite care and attention to detail by Brian Steinhobel, one of the world's leading designers, to add a distinctive touch of stylish sophistication to your home. The environmentally friendly Designer Collection includes superior features that are specifically designed with optimal energy saving, water conservation and safety in mind. In addition there are other functional benefits for the ultimate in adaptability and versatility, from flexible connection tubes and quarter-turn stop taps through to angle regulating valves and many more. These features put the Designer Collection into a class of its own, whether connecting sanitaryware in the bathroom or appliances such as dishwashers in the scullery.

Cobra's Designer Collection epitomises the inspirational genius of this leading light in the field of industrial design. The distinctive Steinhobel style follows the fundamental design principles of form and function, holding true to the belief that contemporary design demands a combination of functionality, aesthetic appeal and optimum space utilisation. There is an ever-increasing need for evolutionary design to create and enhance personal, user-friendly individual living spaces. The end result ideally presents a formidable combination of visionary futuristic appeal together with functional practicality, creating a high impact interior look and feel that exudes exclusivity and sophistication.

We trust that you will enjoy this exclusive collection from Brian Steinhobel, brought to you exclusively by Cobra.



callisto



Nothing but the best

The Callisto range has been designed as functional works of art to add a distinguished touch of glamorous stylishness to any home interior.



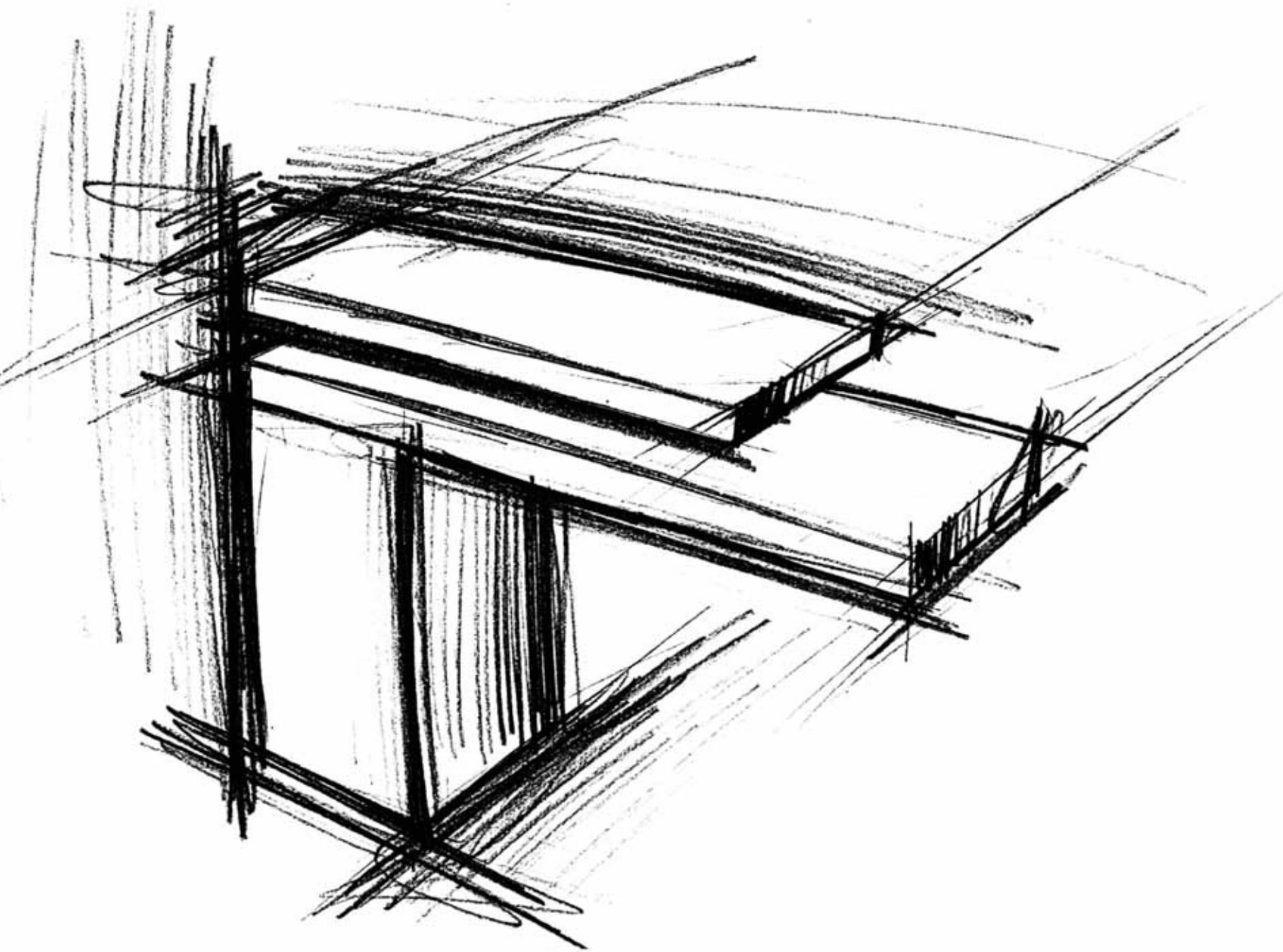





callisto specifications



<p>BASIN MIXER CL-950</p>	 <p>Single lever mixer with pop-up waste, fixing kit and angle valves.</p> <p>Finish: Chrome Plated</p>	<p>RAISED BASIN MIXER CL-951R</p>	 <p>Single lever mixer with pop-up waste, fixing kit and angle valves.</p> <p>Finish: Chrome Plated</p>
<p>BASIN MIXER CL-953</p>	 <p>Single lever mixer with aqua waste, fixing kit and angle valves.</p> <p>Finish: Chrome Plated</p>	<p>BATH/ SHOWER MIXER CL-956</p>	 <p>Single lever undertile mixer.</p> <p>Finish: Chrome Plated</p>
<p>BATH/ SHOWER DIVERTER MIXER CL-961</p>	 <p>Single lever undertile diverter mixer.</p> <p>Finish: Chrome Plated</p>	<p>BIDET MIXER CL-965</p>	 <p>Single lever mixer with pop-up waste, swivel outlet, fixing kit and angle valves.</p> <p>Finish: Chrome Plated</p>
<p>SINK MIXER CL-970</p>	 <p>Single lever mixer with aerated swivel outlet, fixing kit and angle valves.</p> <p>Finish: Chrome Plated</p>	<p>PREP BOWL SET CL-115</p>	 <p>Two hole with pillar spout, fixing kit and side valve.</p> <p>Finish: Chrome Plated</p>

callisto specifications

STOP TAPS CL-128-15		STOP TAPS CL-138-15	
			
One pair undertile stop taps. Finish: Chrome Plated		One pair undertile stop taps with 15 mm copper compression inlets. Finish: Chrome Plated	
BASIN MIXER CL-158		BASIN SPOUT CL-066SQPT210	
			
Three hole with pillar spout with fixing kit and side valves. Finish: Chrome Plated		Pillar type spout with fixing kit. 149 mm throw x 230 mm high. Finish: Chrome Plated	
BATH/ BASIN SPOUT CL-066SQWT220			
			
Wall type spout. 149 mm throw x 153 mm high. Finish: Chrome Plated			

Leading edge



Elegant, expressive and unique

Leading Edge brings you artistic, cutting edge design that is evocative of a celebrity lifestyle and expresses your unique personality and appreciation for the finer things in life.

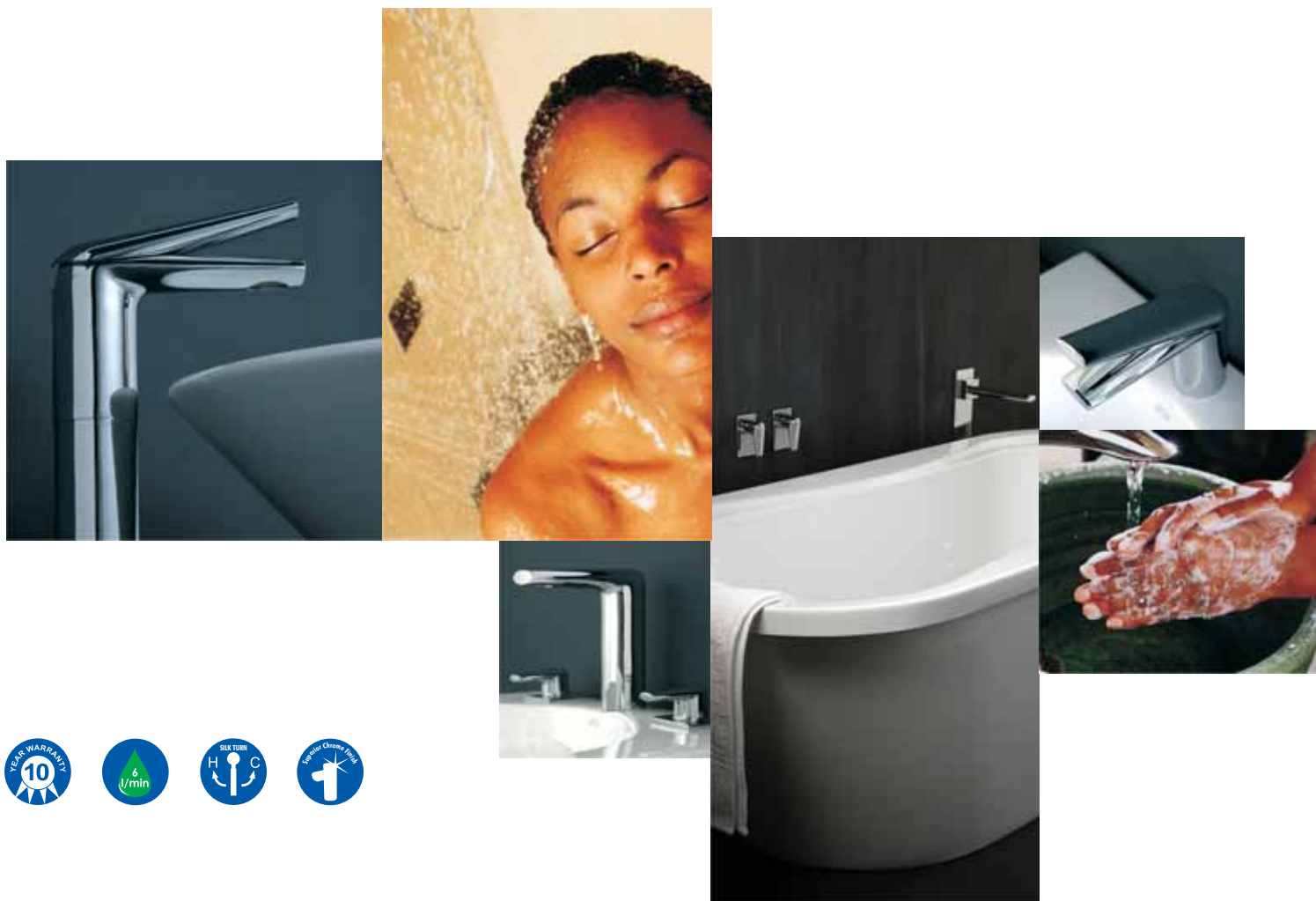

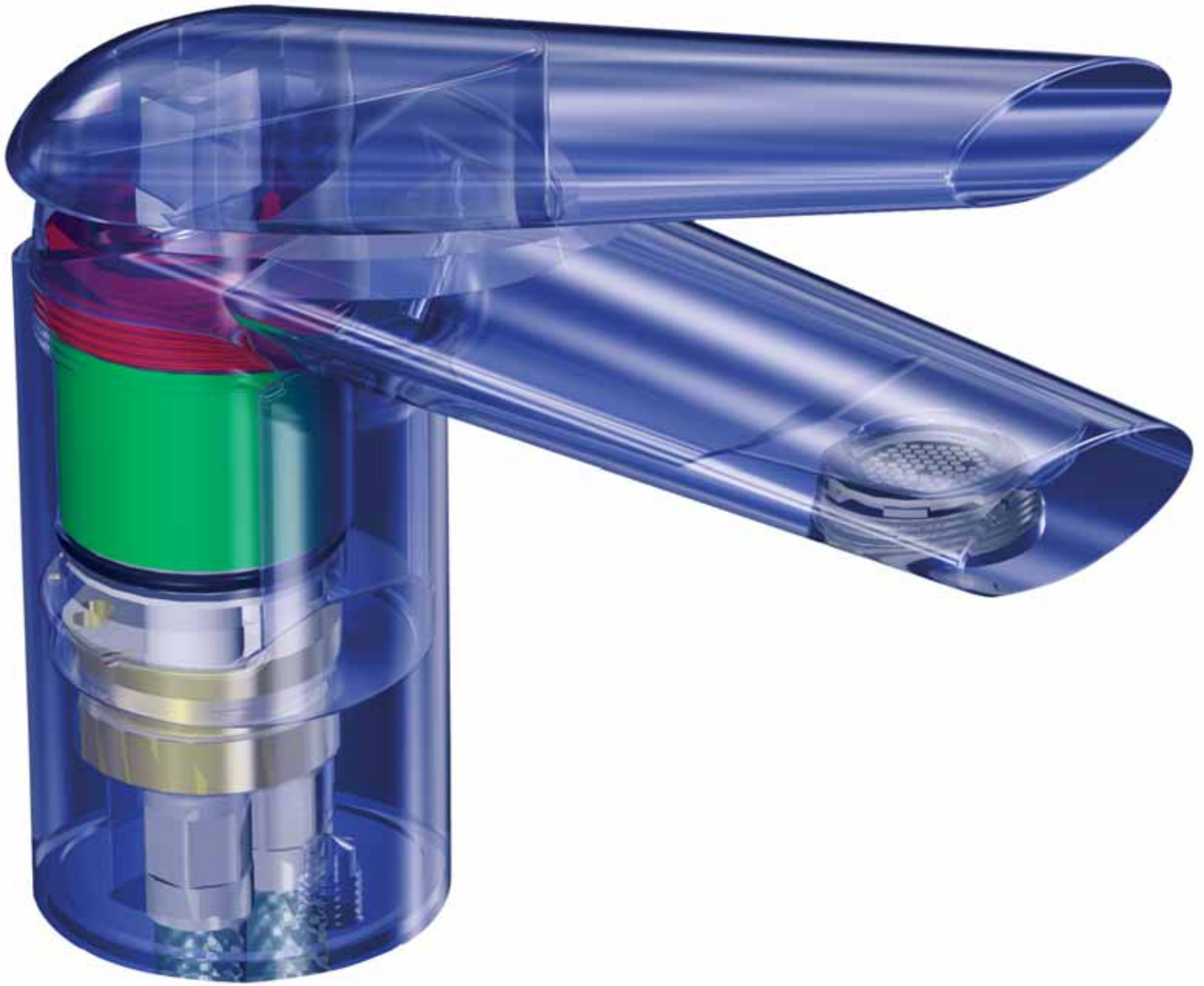

leading edge specifications



<p>BASIN MIXER LE-950</p>	 <p>Single lever with pop-up waste, fixing kit and angle valves.</p> <p>Finish: Chrome Plated</p>	<p>RAISED BASIN MIXER LE-951R</p>	 <p>Single lever mixer with pop-up waste, fixing kit and angle valves.</p> <p>Finish: Chrome Plated</p>
<p>BASIN MIXER LE-953</p>	 <p>Single lever with aqua waste, fixing kit and angle valves.</p> <p>Finish: Chrome Plated</p>	<p>BATH/ SHOWER MIXER LE-956</p>	 <p>Single lever undertile mixer.</p> <p>Finish: Chrome Plated</p>
<p>BATH/ SHOWER DIVERTER MIXER LE-961</p>	 <p>Single lever undertile diverter mixer.</p> <p>Finish: Chrome Plated</p>	<p>BIDET MIXER LE-965</p>	 <p>Single lever mixer with pop-up waste, swivel outlet, fixing kit and angle valves.</p> <p>Finish: Chrome Plated</p>
<p>PREP BOWL SET LE-115</p>	 <p>Two hole with pillar spout, fixing kit and side valve.</p> <p>Finish: Chrome Plated</p>	<p>STOP TAPS LE-128-15</p>	 <p>One pair undertile stop taps.</p> <p>Finish: Chrome Plated</p>

leading edge specifications

STOP TAPS LE-138-15	 <p>One pair undertile stop taps with 15mm copper compression inlets.</p> <p>Finish: Chrome Plated</p>	BASIN MIXER LE-158	 <p>Three hole with pillar spout with fixing kit and side valves.</p> <p>Finish: Chrome Plated</p>
SIDE VALVES LE-21/522	 <p>One pair with 1/4" turn ceramic disc headparts.</p> <p>Finish: Chrome Plated</p>	BASIN SPOUT LE-066PT140	 <p>Pillar type spout. 110 mm throw x 140 mm high</p> <p>Finish: Chrome Plated</p>
BASIN SPOUT LE-066PT210	 <p>Pillar type spout. 110 mm throw x 210 mm high</p> <p>Finish: Chrome Plated</p>	BATH/ BASIN SPOUT LE-066WT220	 <p>Wall type spout. 220 mm throw</p> <p>Finish: Chrome Plated</p>

tapno

Sleek, stylish and sophisticated

Sleek, stylish and simply perfect in form and function, design and detail, Tapno bears testimony to your impeccable good taste and desire for perfection and sophistication.



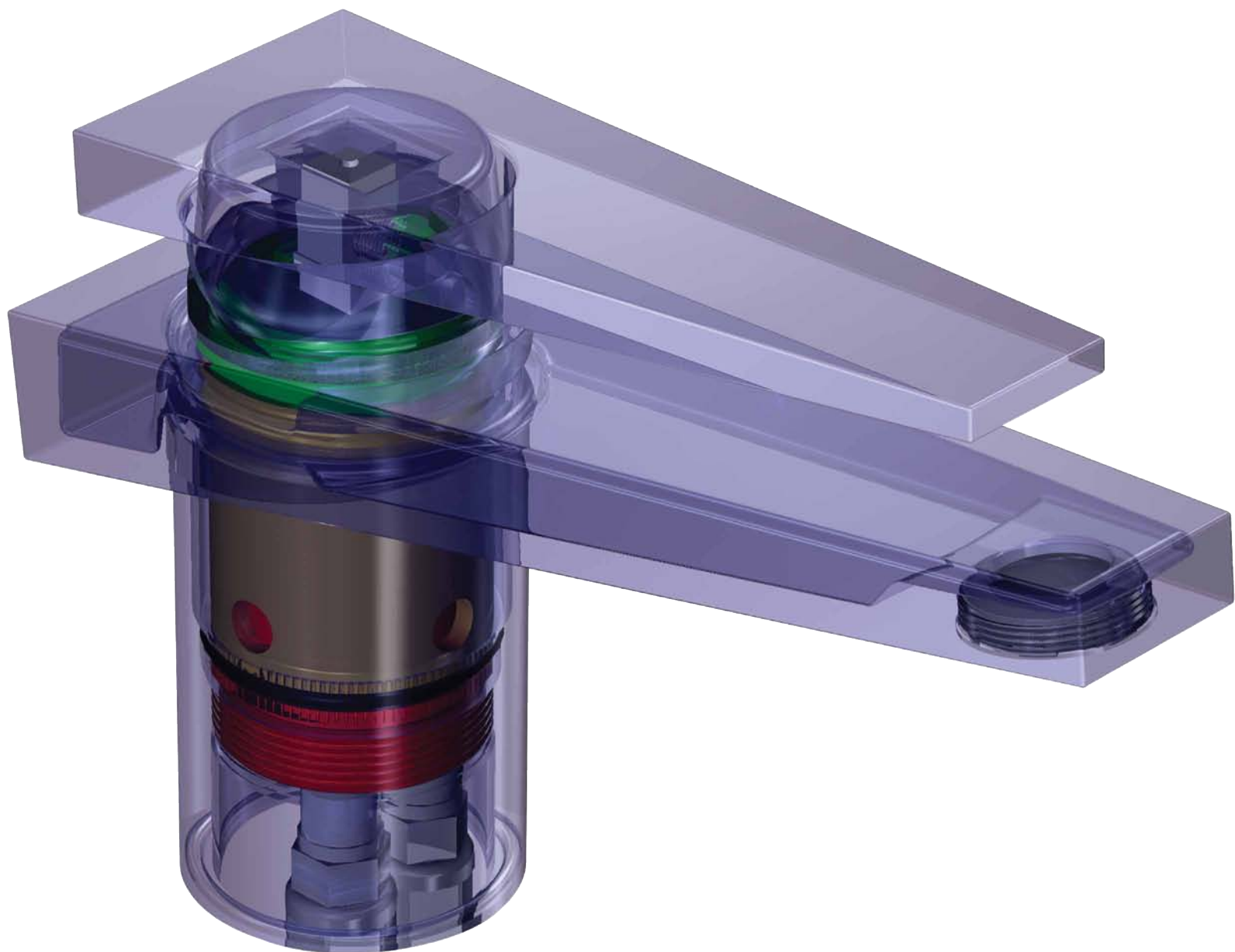

tapno specifications



BASIN MIXER TN-950	 <p>Single lever mixer with pop-up waste, fixing kit and angle valves.</p> <p>Finish: Chrome Plated</p>	<p>Single lever mixer with fixing kit and angle valves.</p> <p>Finish: Chrome Plated</p>	<p>RAISED BASIN MIXER TN-951R</p> 
BASIN MIXER TN-953	 <p>Single lever mixer with aqua waste, fixing kit and angle valves.</p> <p>Finish: Chrome Plated</p>	<p>Single lever undertile mixer.</p> <p>Finish: Chrome Plated</p>	<p>BATH/ SHOWER MIXER TN-956</p> 
BATH/ SHOWER DIVERTER MIXER TN-961	 <p>Single lever undertile diverter mixer.</p> <p>Finish: Chrome Plated</p>	<p>Single lever bidet mixer with pop-up waste, swivel outlet, fixing kit and angle valves.</p> <p>Finish: Chrome Plated</p>	<p>BIDET MIXER TN-965</p> 
PREP BOWL SET TN-115	 <p>Two hole with pillar spout, fixing kit and side valve.</p> <p>Finish: Chrome Plated</p>	<p>One pair undertile stop taps.</p> <p>Finish: Chrome Plated</p>	<p>STOP TAPS TN-128-15</p> 

tapno specifications

STOP TAPS TN-138-15	 <p>One pair undertile stop taps with 15 mm copper compression inlets.</p> <p>Finish: Chrome Plated</p>	<p>Three hole with pillar spout with fixing kit and side valves.</p> <p>Finish: Chrome Plated</p>	<p>BASIN MIXER TN-158</p> 
SIDE VALVES TN-21/522	 <p>One pair side valves with ¼" turn ceramic disc headparts.</p> <p>Finish: Chrome Plated</p>	<p>BASIN SPOUT TN-066TRPT140</p> <p>Pillar type spout, with fixing kit. 127 mm throw x 144 mm high.</p> <p>Finish: Chrome Plated</p>	
BASIN SPOUT TN-066TRPT210	 <p>Pillar type spout with fixing kit. 128 mm throw x 213 mm high.</p> <p>Finish: Chrome Plated</p>	<p>BATH/ BASIN SPOUT TN-066TRWT220</p> <p>Wall type spout. 220 mm throw.</p> <p>Finish: Chrome Plated</p>	





Cobra taps and fittings are manufactured to exceed the SABS requirements. Cobra use dezincification resistant (DZR) brass and high quality components.

Cobra Watertech (Pty) Limited

P. O. Box 1096, Krugersdorp 1740, South Africa

T: (011) 951 5000

E: marketing@cobrawatertech.co.za

www.cobra.co.za

Branches:

Johannesburg (Sales and Showroom)

T: (+2711) 875 7400

Cape Town (Sales and Showroom)

T: (021) 510 0970

Port Elizabeth (Sales and Showroom)

T: (041) 367 4730

Durban (Sales and Showroom)

T: (031) 303 8400

Bloemfontein

T: (071) 482 2328

Mpumalanga/ Limpopo

T: (011) 875 7400

International

T: (+2711) 951 5104

F: (+2711) 951 5002

E: export@cobrawatertech.co.za

After Sales Service

T: 0861 21 21 21

Full service back up and spare available.

www.cobra.co.za

www.cobra.co.za/mobi

