

TECHNICAL RANGE

# Medical Mixers

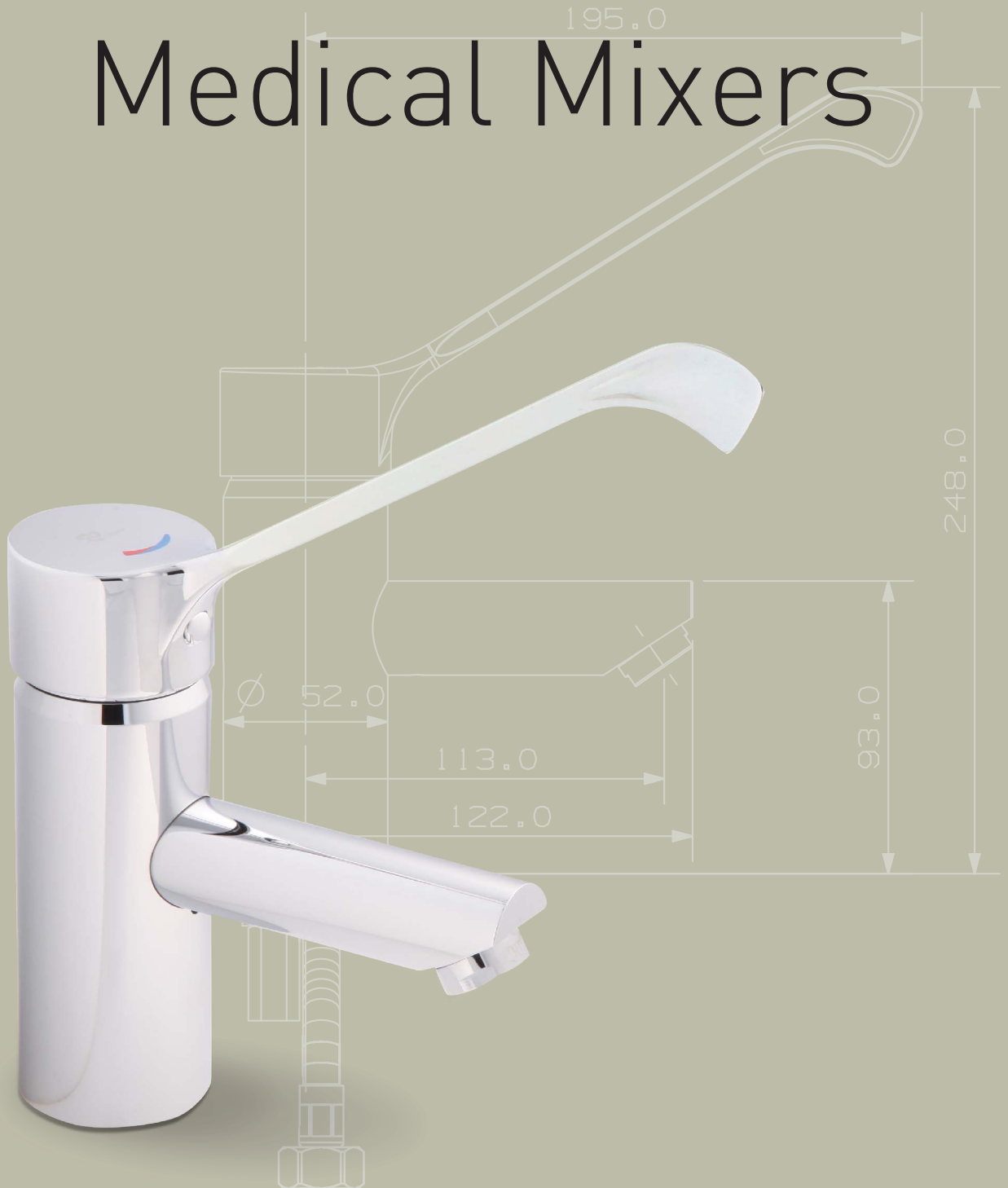

**COBRA**  
A SOUTH AFRICAN ICON



---

# Medical Mixers

## Features and Benefits

- Application: Ideal for medical, kitchen and industrial applications.
  - Clockwise and Anti-clockwise closing mechanism: A ¼ turn ceramic disk head part facilitates the opening and closing of bib taps, pillar taps and side valves with a ¼ turn action.
  - Aerated flow restrictors: All single lever mixers come standard with a 5l/min aerated flow restrictor, facilitating water saving and supporting green building requirements.
  - Dezincification Resistant (DZR) Brass: It is documented that the corrosion products of dezincified brass support the growth of pathogens such as Legionella (Legionnaires disease). The use of dezincification resistant Cobra brass products reduce this risk factor.
  - Spares: Should you require spares, even for older Cobra models, you are assured of the availability of such componentry and sub-assemblies since Cobra retains spares for models as old as 20 years, thus ensuring the continued operation of your existing Cobra fittings.
  - Dry Outlet design: Designed as a feature specific to the bib and pillar taps in the medical range, this mechanism ensuring that all potential water that remains within the tap chamber runs from the outlet, thus eliminating water that can perpetuate the growth of bacteria.
  - Operating handle: Angled away from the spout, the 180mm long handle ensures ease of use, particularly for users with limited mobility since the handle can be operated with both elbow and forearm. The handle has no sharp edges, eliminating any threat of injury.
  - Progressive cartridge: This mechanism reduces the wastage of hot water when compared with traditional single lever cartridges. When the spindle is turned clockwise, it opens the volume flow of cold water. Turning the spindles further activates the mixing process by adding hot water. At the end of the turning area, only hot water flows. This feature is specific to the medical ranges single lever basin mixer as well as wall type and pillar type mixers. The progressive cartridge also has a base temperature limiter safety function, to prevent scalding at high temperatures.
  - S-connections with integrated shut off valve: Added as a feature to the wall type and pillar type mixers, allowing for maintenance to be conducted on the mixers without having to shut off water at the mains.
  - Chrome plated: All items are chrome plated ideal for sterile environments.
  - JASWIC: The Cobra Medical range is listed with the joint acceptance scheme for water services installation components.
-



### BIB TAP

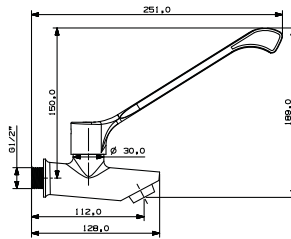

**Description:** ¼ turn elbow action bib tap with a dry spout design that eliminates stagnated water that can foster the growth of bacteria.  
½" BSP male inlet. SANS 226 TYPE 2

**Code:** NM-500-21B



### BIB TAP

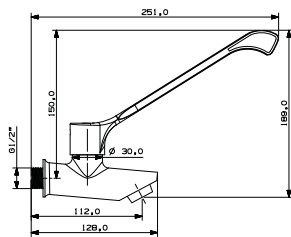

**Description:** ¼ turn elbow action bib tap with a dry spout design that eliminates stagnated water that can foster the growth of bacteria.  
½" BSP male inlet. SANS 226 TYPE 2

**Code:** NM-500-21R



### PILLAR TAP

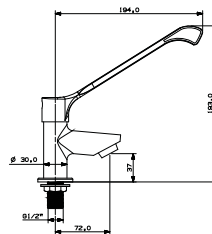

**Description:** ¼ turn elbow action pillar tap with a dry spout design that eliminates stagnated water that can foster the growth of bacteria.  
½" BSP male inlet. SANS 226 TYPE 2

**Code:** NM-502-21B



### PILLAR TAP

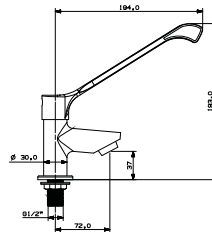

**Description:** ¼ turn elbow action pillar tap with a dry spout design that eliminates stagnated water that can foster the growth of bacteria.  
½" BSP male inlet. SANS 226 TYPE 2

**Code:** NM-502-21R



## SIDE VALVE

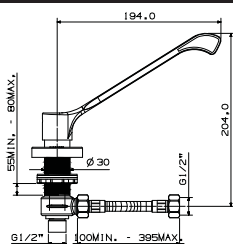

**Description:** ¼ turn elbow action side valve. ½" BSP male inlet.  
SANS 226 TYPE 2

**Code:** NM-514-21R



## SIDE VALVE

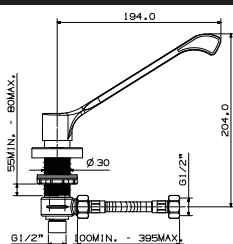

**Description:** ¼ turn elbow action side valve. ½" BSP male inlet.  
SANS 226 TYPE 2

**Code:** NM-514-21B



## HOSE BIB TAP WITH A TRIGGER SPRAY

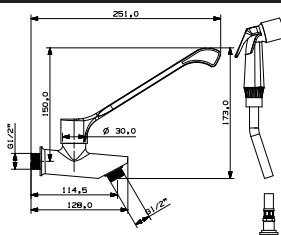

**Description:** ¼ turn elbow action bib tap with trigger spray. ½" BSP male inlet.  
SANS 226 TYPE 2

**Code:** NM-519-21



## BASIN MIXER

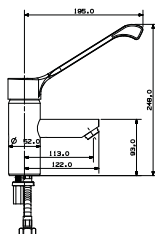

**Description:** Single lever elbow action basin mixer with progressive cartridge.  
½" BSP female inlets. SANS 1480

**Code:** NM-851





### RAISED BASIN MIXER

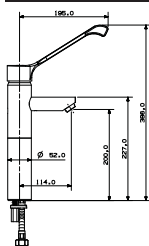

**Description:** Single lever elbow action raised mixer with progressive cartridge. ½" BSP female inlets. SANS 1480

**Code:** NM-851R



FLOW RATE



### WALL TYPE MIXER

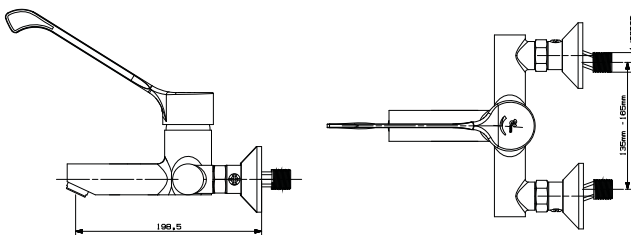

**Description:** Single lever elbow action wall type mixer with progressive cartridge. ½" BSP male inlets. SANS 1480

**Code:** NM-859

**Note:** Not to be used for Bath applications due to flow rate restrictions.



### WALL TYPE DIVERTER MIXER & HAND SHOWER

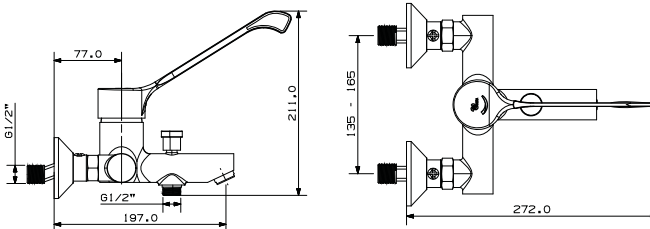

**Description:** Single lever elbow action wall type diverter mixer with a hand shower, hose and holder. ½" BSP male inlets. SANS 1480

**Code:** NM-859SET1

**Note:** Not to be used for Bath applications due to flow rate restrictions.



### PILLAR TAP MIXER

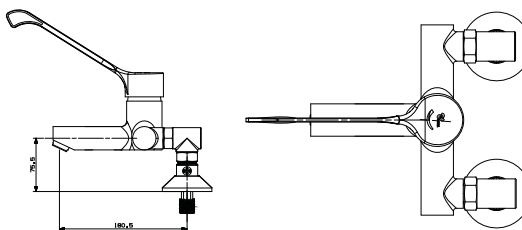

**Description:** Single lever elbow action pillar type mixer with progressive cartridge. ½" BSP male inlets. SANS 1480

**Code:** NM-858

**Note:** Not to be used for Bath applications due to flow rate restrictions.





**COBRA**  
A SOUTH AFRICAN ICON



**SABS**  
ISO 9001

Tel: 0861 21 21 21  
Email: [marketing@cobrawatertech.co.za](mailto:marketing@cobrawatertech.co.za)  
[www.cobra.co.za](http://www.cobra.co.za)

