CONTENTS

- 3 **Franke Overview**

- 4 **Franke WS Design A Bathroom Competition**
Finalists & Top 20 Designs

- 10 **Franke Academy**
New Interactive Training Facility

- 12 **Recently Supplied Projects**
Hospitals, Commercial & Other Projects where Franke
Products were supplied

- 25 **New Products**
New Franke Products available

- 34 **Zip HydroBoil Packaging**
The new look Zip HydroBoil Packaging

- 35 **Franke 2013 Product Guides**

- 35 **Professional Associations**
Professional Associations that Franke Washroom
Systems are affiliated to

Dear Customer

I am delighted to present this, the first publication of the Franke South Africa Washroom Systems (WS) newsletter.

This is a wonderful platform from which to inform you on some of the more notable achievements of our Washroom Systems Division. These include:

1. Our investment in technology and sustainable growth;
2. Our interactive 3D rendering competition;
3. Our new training facility located at our factory in Durban;
4. Projects which we have been involved in;
5. Some new and innovative products and
6. Our new revamped product guides.

Franke South Africa showed good sales growth in 2012 in spite of a challenging market. I am happy to say that it appears that we will continue to build on this success in 2013. This achievement is the result of the loyalty of our customers, the dedication and energy of our people and the quality of the product sold under the Franke brand.

I thank everyone at Franke South Africa for their energy, teamwork and loyalty. I am conscious how important these are to the success of the Franke brand in Africa. I especially give thanks to my team leaders, Schalk de Beer (Commercial Manager FSA), Craig McIntyre (Operations Manager FSA) and Bill Harris (Technical Manager FSA). I also acknowledge the superb effort of the Washroom System Division's Sales Team.

A big thanks to you, our customer, for your loyalty and support over the years. Let's continue to grow our businesses together.

I invite you to visit our new Training Centre, Operations Plant and Sales Team in Mobeni, Durban.

Yours sincerely



Alan Palmer
Managing Director



STUDENT AND PROFESSIONAL ALIKE, AMAZE WITH THEIR BREATHTAKING DESIGNS

THE FRANKE WS DESIGN A BATHROOM COMPETITION WAS RUN BETWEEN 1ST MAY 2012 AND 30TH SEPTEMBER 2012. THESE ARE THE DETAILS AS WELL AS THE WINNING AND TOP 20 DESIGNS

FRANKE DESIGN A
BATHROOM COMP



Franke Washroom Systems is a world leading provider of intelligent washroom solutions to the public, semi-public and commercial sector. We are expert partners, dedicated to creating complete washroom systems that outshine the rest in functionality, design and durability.

Franke Washroom Systems recently ran a competition open to Professional Architects and Interior Designers as well as Student Architects and Interior Designers. The brief was to design a public ablution using Franke Washroom System products and submit 3D renders of their designs.

The purpose of the competition was to introduce the public to the hygiene of stainless steel bathroom products in the everyday bathroom environment, and step away from the idea that stainless steel is industrial, impersonal and cold.

Professional Category:

Philip Darby, Professional Interior Designer of PDI Design Consultants, really raised the bar with his winning design which portrayed a high-end bathroom design with 3D renders that left you wondering if they were in fact renders or photographs. This design awarded Philip with 1st prize, an all expense paid trip to the ISH Plumbing and Sanitaryware Fair in Germany in March 2013. He will be accompanied by Suria Ramnarain of our Gauteng Sales Department.

While the judging took place, it became very clear that it wasn't as clean cut as one winner, as the concept of the designs varied across the board, and not all of them could be rated on the same scale. It is for that reason that a best professional concept design was awarded to Stephen Parkes, of AdlerPrice Architects. While his design may not have portrayed the Franke products accurately or made much focus on them, the concept of the futuristic bathroom kept everyone thinking. Stephen was awarded a Zip MiniBoil Elite Tap for his design.

DESIGN A BATHROOM COMPETITION - PROFESSIONAL CATEGORY

Student Category:

The student category really added value to the competition, as it allowed us to recognise the impact fresh ideas can have on design. Murray Farquharson, of BHC School of Design took first prize with the submission of a single 3D render. His clean cut image of a corporate bathroom left no doubt in the judges minds, Murray deserved the R5000 cash prize.

Andrew Mboyi, an architect student from Nelson Mandela Metropolitan University, submitted 3 designs in the student category. It was known immediately that, after Murray, he was a sure winner, the only debate was which design? After much deliberation, a decision was made and Andrew was awarded his cash prize of R2000.

Who doesn't dream of a beach retreat in Mauritius? An idea very well utilised by Simone Biggs. An interior design student at Cape Peninsula University of Technology, Simone's design created a longing to escape to the haven she had created. This alone made it very clear, that although she did not represent the Franke products very clearly, her design was worth of the Best Concept in the student category earning herself R1500.

We are proud to say that the competition was endorsed by the IID (South African Institute of Interior Design Professional). The IID is the only professional body representing the Interior Design industry in South Africa. The Institute is dedicated to establishing, promoting and

maintaining expertise, professionalism, sound business practice and high standards throughout the industry.

After the preliminary round of checking each design against the basic entry requirements, Jocelyn Jones, CEO of Jossi Design, is the KZN Regional Head and the President Elect of The South African Institute for The Interior Design Professions (The IID). and Gareth Nezar, owner and architect of Arkus Architects were invited in as our external judges on the panel who selected the winners from a large selection of submissions received.

The WS Design a Bathroom Competition was included as part of Cape Peninsula University of Technology and University of Johannesburg Interior Design syllabus.

After seeing the success of this competition as well as seeing the quality of the designs that were submitted, Franke Washroom Systems is considering the Design a Bathroom Competition to be a Bi-Annual event.

All 5 winning designs, as well as the Top 20 Designs can be viewed at www.frankedesign.co.za.



Handing over the 1st Prize in the Professional Category to professional Interior Designer, Philip Darby of PDI Design Consultants

Below (from left to right):

Clinton Soutter - Franke National Sales Manager, Leigh-Anne Robertson - Franke Marketing Coordinator, Philip Darby - PDI Design Consultants, Schalk De Beer - Franke Commercial Manager, Alan Palmer - Franke Managing Director

DESIGN A BATHROOM COMPETITION - PROFESSIONAL CATEGORY

FRANKE DESIGN A
BATHROOM COMP



Reproduction of any of the content, full or partial, is allowed only with prior written approval for Franke Kitchen Systems (Pty) Ltd

DESIGN A BATHROOM COMPETITION - PROFESSIONAL CATEGORY



Best Concept Design by Stephen Parkes

Right: Stephen Parkes receiving his prize from Franke Coastal Regional Manager, Nico Claase

FRANKE DESIGN A
BATHROOM COMP

DESIGN A BATHROOM COMPETITION - STUDENT CATEGORY



Winning Student Design by Murray Farquharson

Left: Murray Farquharson receiving his prize from Franke Coastal Regional Manager, Nico Claase

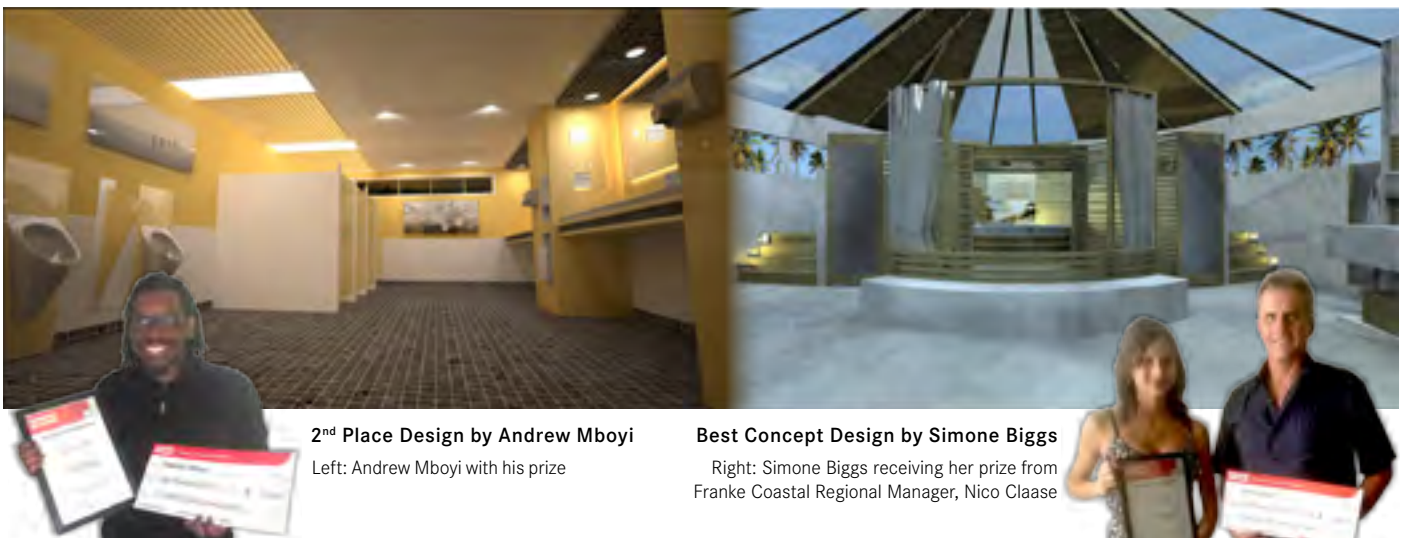

2nd Place Design by Andrew Mboyi

Left: Andrew Mboyi with his prize

Best Concept Design by Simone Biggs

Right: Simone Biggs receiving her prize from Franke Coastal Regional Manager, Nico Claase

DESIGN A BATHROOM COMPETITION - TOP 20 DESIGNS

(excluding the 5 winning designs)

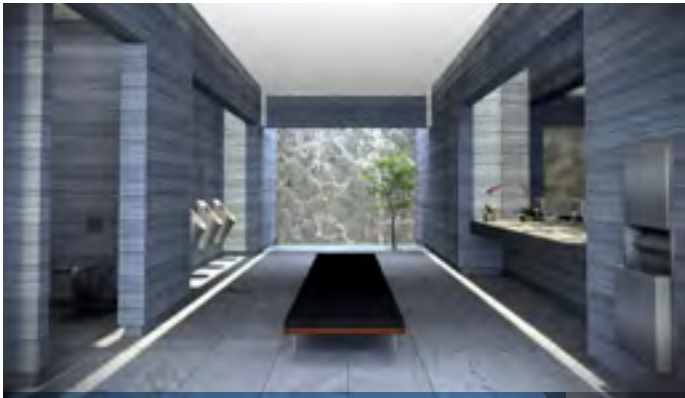

Stephen Parkes - AdlerPrice Architects



Victor Okoth - Arch Three Design



Marlize Nel - Hennie Lambrechts Architects



Pieter-Schalk Botha - TJ Architects



Marc Chong-Seng - X3 Architects



Andrew Mboyi - Nelson Mandela Metropolitan University



Tarné Leng - Cape Peninsula University of Technology



Tuami Zulu - Design School Southern Africa

DESIGN A BATHROOM COMPETITION - TOP 20 DESIGNS

(excluding the 5 winning designs)

FRANKE DESIGN A
BATHROOM COMP



Nikki van den Aardweg - Cape Peninsula University of Technology



Stephanie Leukis - University of Johannesburg



Avelile Nontando - Cape Peninsula University of Technology



Cara Gonsalves - University of Johannesburg



Emmanuel Indongesit - University of Uyo Akwa Ibom State Nigeria



Monique Diergaardt - Cape Peninsula University of Technology



Frank Kleinschmidt



3Formed 3D Communication

FRANKE ACADEMY - NEW INTERACTIVE TRAINING FACILITY

NEW INTERACTIVE
TRAINING FACILITY

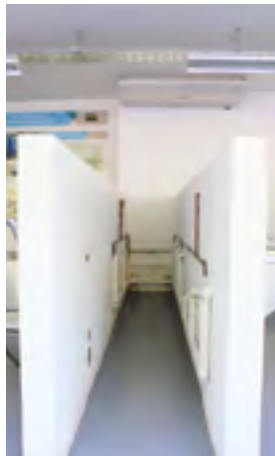

FRANKE ACADEMY - NEW INTERACTIVE TRAINING FACILITY

Franke recognized the needs on training and as such invested R2 million in a new training facility at it's Durban factory.

The new facility is fully plumbed to enable architects, plumbers and end users to share their experience with us and by doing so continue to develop products to meet market demands .

Setting up of the new training facility proved to be a challenge as our products can be use in a wide range of applications but in the end we have now installed products in sections such as:

- Washroom Systems
- Sanitaryware and Laundry Products
- Security Products
- Hospital Products
- Mortuary Products
- Deko Disinfection Units
- Zip Instant boiling Water & Chillers

The training facility also includes a fully interactive white board to enable electronic filing and communication.

All training scripts have been completed and we look forward to visits from our clients in this regard, and continue to develop skills and products through interactive training and communication.

Should you require any assistance, please contact Vanessa Revie at 031 450 6300

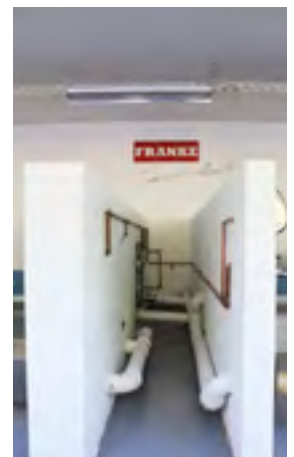
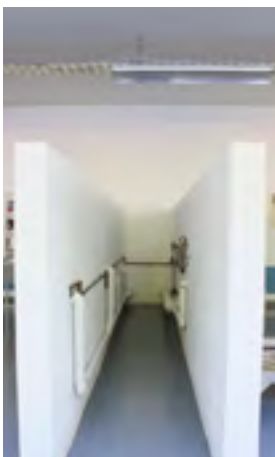

RECENTLY SUPPLIED PROJECTS - SOUTH AFRICA

Hospital Projects

SLOP HOPPERS, DRIP SINKS, BOTTLE RACKS, BED PAN WASH-UP, SURGEON SCRUB UP UNITS, PLASTER OF PARIS SINKS, BATHS

Franke is the leading supplier of sanitaryware products to hospitals, clinics and mortuaries, environments where hygiene is of the highest priority.

Franke is certified to ISO9001: 2008 quality management standards.

Our designs and construction ensure that our products meet the demands of safety, hygiene and quality.

Uncompromising when it comes to quality, innovation and design.

TROLLEYS, BODY TRAYS, INSTRUMENT CABINETS, WRITING DESKS

With over 100 years experience in precision stainless steel fabrication and metalwork, Franke have designed a customised range of products for mortuaries, post mortem and autopsy rooms.

All mortuary, autopsy and post mortem equipment is manufactured in top quality Grade 304 & 316 stainless steel, for durability and hygiene

SINKS, TABLES, WALL BENCHES AND SHELVING

Heavy duty industrial sinks and tables with sound deadening under frames.

The range is complimented by a selection of modular designed shelving systems for medical and catering applications.

RECENTLY
SUPPLIED PROJECTS

Red Cross War Memorial Children's Hospital - Cape Town, Western Cape

RED CROSS WAR MEMORIAL CHILDREN'S HOSPITAL:

Red Cross War Memorial Children's Hospital is South Africa's only dedicated child health institution and offers a comprehensive range of specialist paediatric services to children. It is a centre of excellence for the training of all categories of child health professionals.

Children from all nine provinces and from all over Africa are referred to Red Cross War Memorial Children's Hospital by referral hospitals, clinics and smaller hospitals. The hospital is active in paediatric outreach and support programmes across South Africa.

Red Cross War Memorial Children's Hospital is regarded as South Africa's leading centre for postgraduate specialist paediatric medical and surgical training. The hospital's tertiary facility provides comprehensive dedicated paediatric services with a full range of sub-specialties at quaternary, tertiary and secondary levels of care.

Contract Details:

Architect:	KMH Architects
Contractor:	Gossouw & Harding Construction
Plumber:	HIS Plumbing
Merchant:	Plumbink
Date commenced:	1 November 2011
Date completed:	1 May 2012

Franke products supplied to the project:

- Sluice Sinks
- Slop Hoppers
- Wash Hand Basins
- Purpose Made Sinks



Purpose Made Sink

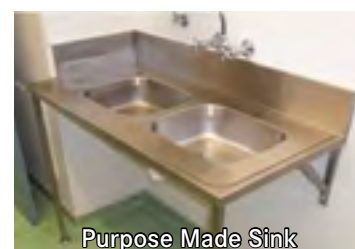

Purpose Made Sink



Sluice Sink

RECENTLY SUPPLIED PROJECTS - SOUTH AFRICA

Hospital Projects

Provincial Hospital - Port Elizabeth, Eastern Cape



Port Elizabeth's large Provincial government funded hospital, Port Elizabeth Provincial Hospital, is a tertiary teaching hospital and forms part of the Port Elizabeth Hospital Complex.

Contract Details:

Architect:	BNM Architects PE
Contractor:	GVK Siya Zama
Plumber:	Spot on Plumbers
Contract Started:	Mid 2011
Contract completed:	March 2012

Franke products supplied to the project:

- Deko 190 Bed Pan Washers
- CH Slop Hoppers
- Sluice Sinks
- Bottle Racks
- Wash Hand Basins
- Zip HydroBoil
- Industrial Sinks



Oval B Wash Hand Basin



Purpose Made Sinks



Purpose Made Sinks & HydroBoil



Sluice Sink



Slop Hopper & Deko 190

RECENTLY SUPPLIED PROJECTS - SOUTH AFRICA

Hospital Projects

Netcare Waterfall City Hospital - Midrand, Gauteng

Netcare Waterfall City Hospital in partnership with Phelang Bonolo is a multi-disciplinary healthcare facility. It is conveniently located just off Allandale Road in Midrand, Gauteng, making it the closest ICU facility to the M1 highway. The hospital's state-of-the-art equipment is complimented by highly skilled doctors, professional staff and a dynamic management team, who are committed to providing exceptional care for patients and their families.

Contract Details:

Architect:	VDO Consultants
Contractor:	WBHO
Plumber:	WBHO
Merchant:	Plumblink
Date commenced:	November 2010
Date completed:	January 2012

Franke products supplied to the project:

- Surgeon Scrub-Up Units
- Sluice Sinks
- Slop Hoppers
- Quinline Sinks
- Zip HydroBoil
- Prep Bowls

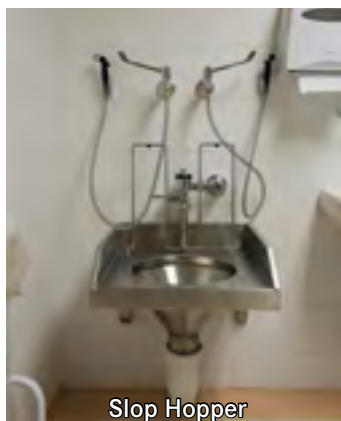

Slop Hopper



Sluice Sink



Quinline Sink

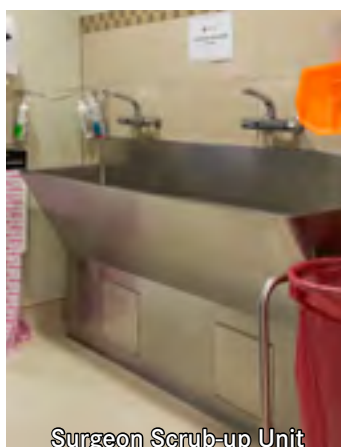

Surgeon Scrub-up Unit



Prep Bowl & Zip HydroBoil

RECENTLY SUPPLIED PROJECTS - SOUTH AFRICA

Hospital Projects

K-RITH Research Institute for TB and HIV - Durban, Kwa Zulu-Natal



The Kwa Zulu Natal research institute for tuberculosis & HIV was established on 6th August 2009 to tackle one of humanity's major global health challenges, that of HIV & TB co-infection.

The new K-RITH building project is located on the campus of the University of Kwa Zulu Natal's Nelson Mandela School of Medicine in Durban & completion date is end of July 2012.

The new institute is housed in a state-of-the-art, 40,000 sq. ft. research building on the campus of the Nelson R. Mandela School of Medicine on the UKZN campus in Durban, South Africa. The building contains approximately 6,000 sq. ft. of bio safety level-3 laboratory space to enable the safe handling of HIV and the bacteria that cause TB, mycobacterium tuberculosis and drug-resistant m. tuberculosis.

This foundation is funded by Howard Hughes foundation in the USA

The professional team – FGG architects were more inclined to specify Franke stainless steel products due to infection control, quality of products & product functionality.

Contract Details:

Architect:	FGG Architects
Contractors:	WBHO
Plumber:	Monty's Plumbing
Date Commenced:	October 2010
Date Completed:	July 2012

Franke products supplied to the project:

- Zip HydroBoil
- Purpose Made Sinks
- Slop Hoppers
- Z-Series Shelving
- Wash Hand Basins



Slop Hopper



Purpose Made Sink



L Shaped Purpose Made Sink



Z-Series Shelving



Purpose Made Sink

RECENTLY SUPPLIED PROJECTS - SOUTH AFRICA

Hospital Projects

King George V Hospital - Durban, Kwa Zulu-Natal

In 1939, King George V Jubilee Hospital was officially opened with 139 beds for the treatment of Tuberculosis patients. The world war produced a wave of industrial development in the cities, and a lack of proper living conditions for labourers newly recruited from the districts. This caused a tremendous growth of T.B. in South Africa. By 1956 the Springfield Hospital had been taken over and both hospitals were combined with a total number of 1291 beds and became known officially as King George V Hospital.

Due to the vintage of the initial building and the hospital, all the facilities are in a bad state. The redevelopment plans are in full swing and the building activities are taking place parallel with the hospital services.

King George V hospital serves an entire population of \pm 9 million, including part of the Eastern Cape.

Franke has been proud to be associated with the rebuilding

Contract Details:

Architect: Osmand Lang Architects
 Contractors: Armstrong Construction
 Plumber: Monty's Plumbing / Isidingo Plumbers
 Date Commenced: May 2012
 Date Completed: September / November 2013

Franke products supplied to the project:

- Slop Hoppers
- Plaster of Paris Sinks
- Sluice Sinks
- Industrial Sinks
- Baby Baths
- Surgeons Scrub Up Units



Baby Bath



Sluice Sink



Zip HydroBoil



Slop Hopper

RECENTLY SUPPLIED PROJECTS - SOUTH AFRICA

Hospital Projects

Paarl Hospital - Paarl, Western Cape



The overhaul of Paarl Hospital in the Western Cape was aimed towards facilitating the ability of the hospital to fulfil its role as a Level Two Hospital for the local population of the Cape Winelands. The construction of Phase Two began in April 2008, and all additional work was successfully completed during 2010.

Enhancements to the facility included: an upgraded administration block; psychiatric block; provision for a specialist out-patient department; training facilities; upgraded site security and access control; an on-site helipad for the emergency services; administrative offices; as well as renovated residential accommodation for medical and nursing staff. The final value of the project was in the region of R315 million.

Contract Details:

Architect:	Jan Hanekom Architects
Contractors:	Basil Read Construction
Plumber:	WDI Plumbing
Merchant:	Plumblink, Modern Bathrooms
Date Commenced:	2008
Date Completed:	2010

Franke products supplied to the project:

- Deko 190 Bed Pan Washers
- Sluice Sinks
- Drip Sinks
- Slop Hoppers
- DF Drinking Fountains



Oval A Wash Hand Basin

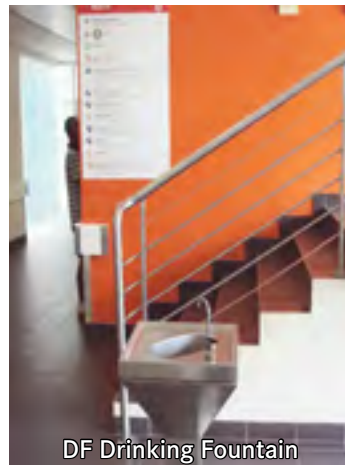

DF Drinking Fountain



Sluice Sink & Deko 190

RECENTLY SUPPLIED PROJECTS - MAURITIUS

Hospital Projects

Dr AG Jeetoo Hospital - Port Louis, Mauritius

The Regional public hospital Dr A. Gaffoor Jeetoo is situated in the district of Port Louis in the Capital of Mauritius. First built in 1733 this major hospital is also one of the oldest.

In October 2009 the project of New Jeetoo Hospital began. It consisted of, building a new wing as well as upgrading and renovating the Hospital. The project budget was announced at Rs2 Billion, fully funded by the Mauritius Government. Gamma Construction was awarded as builder and contractor, Mr Jay Soredoo as Architect and Prodesign as Engineers.

The new Jeetoo Hospital has been operational since June 2012. The Hospital is modern, Functional, spacious while still remaining within Human proportions and equipped with Hi-Tech equipment. The facility is a model of green and smart building.

Contract Details:

Architect: Mr Jay Soredoo & FGG Architects
Contractors: Gama Construction
Date Commenced: October 2009
Date Completed: June 2012

Franke products supplied to the project:

- Sluice Sinks
- Post Mortem Tables
- Slop Hoppers
- Industrial Sinks
- Zip HydroBoils
- Surgeon Scrub-up Units

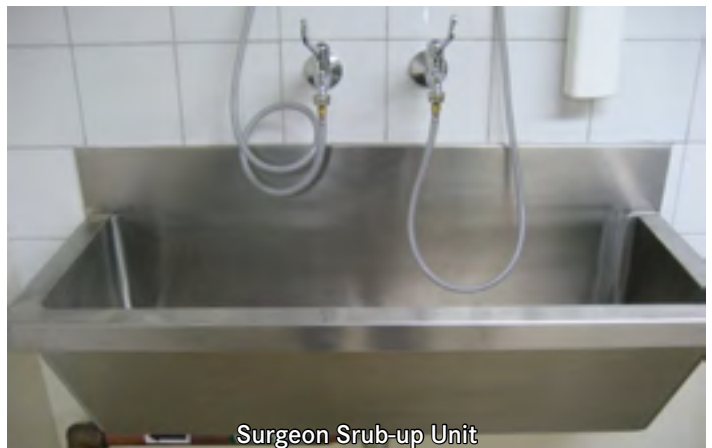

Surgeon Scrub-up Unit



MTS Post Mortem Table



Slop Hopper

RECENTLY SUPPLIED PROJECTS - SOUTH AFRICA

Commercial Projects

Porsche Byanston - Bryanston, Gauteng



Porsche Centre Johannesburg, situated in the Randburg area of the northern suburbs. As part of their mission, not only to ensure the growth of the Porsche brand in South Africa and to provide all Porsche customers with an exceptional ownership experience, they offer a full range of services at the Porsche Centre Johannesburg. Feel free to visit them and enjoy a cup of coffee made from the Zip HydroTap.

Porsche runs a modern sales office and workshop to ensure that quality products can be serviced and maintained.

Contract Details:

Architect:	Empowered Spaces
Q.S:	BTK Centurion
Contractor:	Gothic Construction
Plumber:	Camkay Plumbers
Merchant:	Plumblink Midrand
Date commenced:	October 2007
Date completed:	April 2008

The Zip HydroTap, with undercounter unit, is sleek in design and matches the image of the Dealer.

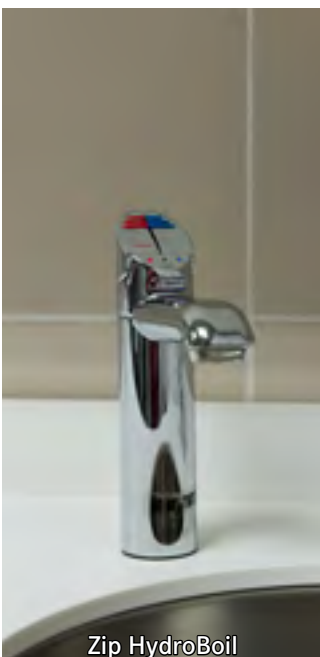

Zip HydroBoil



RECENTLY SUPPLIED PROJECTS - SOUTH AFRICA

Commercial Projects

The Point - Pretoria, Gauteng

This beautiful, A-Grade office block in the centre of Brooklyn is the workplace and offices of Boogertman + Partners.

In recent developments, Boogertman + Partners has joined forces with Geyser Hahn Architects to create a unique service in the healthcare industry.

Boogertman + Partners Architects is an architectural company focusing on design excellence through responsible development and technological innovation.

As gold founder members of the Green Building Council of South Africa Boogertman + Partners are committed to support the environmentally sustainable transformation of the South African and international property industry.

Contract details:

Architect:	Boogertman & Partners
Contractor:	G D Irons
Merchant:	Pat O Kelly
Date commenced:	June 2011
Date completed:	March 2012

Franke products supplied to the project:

- Washroom Accessories - Rodan Range
- Quinline Sinks & Prep Bowls
- Zip HydroBoils



Combination Paper Towel Dispenser & Waste Bin

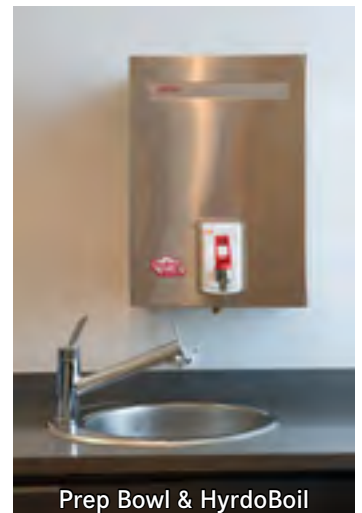

Prep Bowl & HyrdoBoil



Quinline Sink

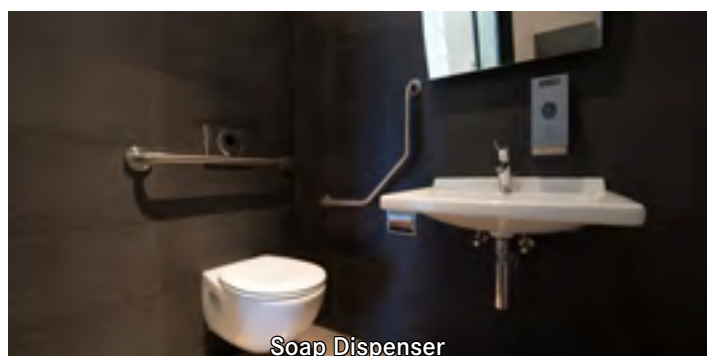

Soap Dispenser

RECENTLY SUPPLIED PROJECTS - SOUTH AFRICA

Commercial Projects

Nedbank - Sandton, Gauteng



The prestigious Nedbank Head Office in Sandton is the first GBCSA Green Star certified building in South Africa, having achieved a 4-star Design rating in October 2009 and a 4-star As-Built rating in September 2010. Phase II completes the Nedbank Campus, located in the heart of the Sandton business district.

The main elements that contributed to the four-star rating include the full economy air conditioning system, the Dali lighting system and energy efficient light fittings, the implementation of an efficient waste recycling system, both during construction and when the building is in use, and the fact that the building would achieve a 30% energy saving when compared with a conventional building.

This includes the use of gas for cooking in the kitchens, Heat Pumps for showers, no hot water in the wash hand basins. It was this principle that opened the door to the use of the Zip HydroTap.

The Zip HydroTap eliminates boiling excessive amounts of water in a kettle and reboiling the same water once it cools, as the boiling water is dispensed in the required portion size at the touch of a finger.

Contract details:

Architect:	GLH Architects
Contractor:	Group 5
Merchant:	Burgess Plumbing
Date commenced:	2008
Date completed:	2010

The Zip HydroTap is sleek in design and matches the image of the Branch



Zip HydroBoil

RECENTLY SUPPLIED PROJECTS - SOUTH AFRICA

Other Projects

Radisson Blu Hotel - Sandton, Gauteng

Situated in Africa's richest square mile, the Radisson Blu Hotel Sandton, Johannesburg offers beautifully appointed guest rooms paired with exceptional service. Boasting an enviable location in the heart of Sandton's business district and just a short distance from some of the continent's best shopping and golf, this world-class hotel makes the perfect base for both business and leisure travellers. Take advantage of this hotel's deluxe facilities including delicious on-site dining options, an outdoor swimming pool, wellness centre and spa and eight modern meeting rooms.

- The hotel is located near the Johannesburg Stock Exchange, the Sandton Convention Centre, Nelson Mandela Square and the impressive Sandton City Shopping Centre.
- Guests appreciate convenient access to OR Tambo International Airport just 30 kilometres away.
- This Johannesburg hotel offers 290 fully furnished guest rooms and 12 penthouses outfitted with first-class amenities such as flat-panel television, satellite channels and Anne Sémonin bath products.
- Vivace delights guests with innovative Italian dishes prepared in a stylish open kitchen.
- The bar and lounge serve an extensive menu of cocktails, wines, coffees and other refreshments.
- An elegant outdoor swimming pool and sun deck, located on the 8th floor, provide the ideal spot to bask in the African sun.
- The hotel houses a modern wellness centre and a spacious fitness centre managed by Amani Spa and Platinum Planet Fitness Gym.
- Secure access-controlled car parking is provided.
- Eight modern, in-house meeting rooms are perfect for small or large corporate meetings and events.

Contract details:

Merchant: Servest Hygiene
Date completed: June 2011

Franke products supplied to the project:

- Washroom Accessories - Stratos Range
- Purpose Made Drip Tray - Bar Area



Paper Towel Dispenser
& Waste Bins



Paper Towel Dispenser
& Waste Bins



Paper Towel Dispenser, Waste Bins,
Toilet Roll Holders & Soap Dispensers



Purpose Made Drip Tray

RECENTLY SUPPLIED PROJECTS - SOUTH AFRICA

Other Projects

Manenberg Human Settlement Contact Centre - Manenberg, Western Cape



A NEW Human Settlements Contact Centre has opened in Manenberg. The aim of the centre is to manage the City of Cape Town's rental stock and dwellings purchased through the City, as well as provide administrative support to ratepayers.

The City of Cape Town's new human settlements contact centre in Manenberg is the second municipal building in South Africa, and the first fully constructed building by the City to have received a 4-Star Green Star SA Office Design Rating v1 certification from the Green Building Council of South Africa showing that government has a green intent.

Materials used in construction were selected for their eco-friendly content and low-carbon footprint in manufacture and delivery. Forestry Stewardship Council certified timber was specified, and recycled plastic bottles were used as insulation material.

Another City building, the electricity services head office located in Bloemhof, also boasts a 4-Star Green Star rating since August last year.

Contract details:

Architect:	City of Cape Town Architects
Contractor:	Good Hope Construction
Plumber:	Good Hope Construction Plumber
Merchant:	Plumbing World
Date commenced:	Jun-11
Date completed:	Mar-12

Franke products supplied to the project:

- Washroom Accessories - Chronos
- Warm Air Hand Dryer RODX310
- 2400 Flat Bed Wash Hand Basin
- Zip Economaster



Zip Economaster

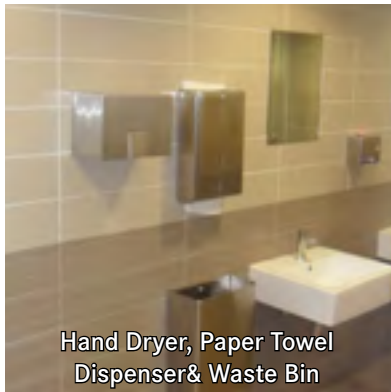

Hand Dryer, Paper Towel Dispenser & Waste Bin



Stainless Steel Mirror, Soap Dispenser, Flat Bed Wash Hand Basin

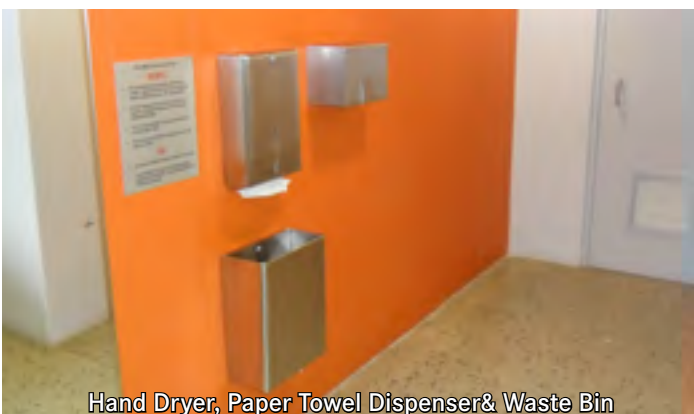

Hand Dryer, Paper Towel Dispenser & Waste Bin

RECENTLY SUPPLIED PROJECTS - SOUTH AFRICA

Other Projects

Ntuzuma Magistrates Court - Ntuzuma, Kwa Zulu-Natal

Bridge City is a new town centre under construction 17 km from the Durban city centre, bridging the communities of Phoenix and Inanda, Ntuzuma and KwaMashu, also known as INK, and linking them to the urban system. The new town will serve as the social and commercial centre to a population of over 800 000 people, who at present have generally poor access to facilities and social services

The award winning architectural building comprises of a 3 storey building comprising of offices, suites, tea kitchens, public & staff ablutions, lower basement & holding cells.

It has been decided that this new court will service the excessive cases that will assist the surrounding areas like Verulam, Phoenix & Inanda.

Such a facility, with regional, district, family, criminal, civil and small claims courts, will alleviate the burden on the Verulam court.

The court is approximately 13136m².

Contract details:

Architect:	JV - DGIT & TJ architects
Contractor:	Group 5 KZN/Pandev
Plumber:	Starling Plumbers
Merchant:	Plumblink/B & B Hardware

Franke products supplied to the project:

- HR2400HD Hand Dryer
- Stratos STRX672 Toilet Roll Holder
- BS618 Soap Dispenser
- Barron Bowl Urinals
- Stratos STRX607 Waste Bin
- Drinking Fountain
- Nouveau Double Bowl Sink
- Rondo RDX6 10-45 Prep Bowl

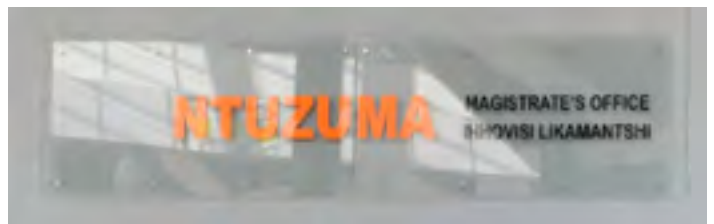

NEW PRODUCTS

WASHROOM ACCESSORIES

Franke WS Accessories Stratos Designer Range with InoxPlus Technology

Stratos - Smart Hygiene Solutions

The Stratos Designer Range has a unique arched design which compliments any washroom, giving the space a coordinated and elegant appearance.



Features

- Designed for heavy duty applications
- Manufactured from Grade 18/10 Stainless Steel
- Easy to clean - the STRATOS range of accessories is surface treated with InoxPlus Technology - which visibly reduces fingerprints.
- Hygienic & vandal resistant



What is InoxPlus Technology:

Franke has created the first stainless-steel surface treatment to use nanotechnology to provide a guaranteed long-lasting, clean finish and appearance.

Properties:

- reduced visibility of fingerprints
- easy to clean
- temperature-resistant 25°C to +80°C
- strong adhesion to the surface
- high abrasion resistance
- resistant against most cleaners
- resistant against acids and alkaline fluids used in household cleaners

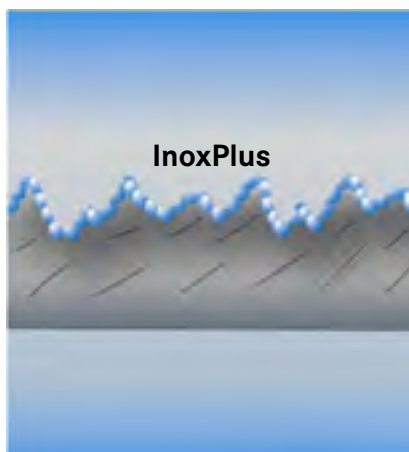
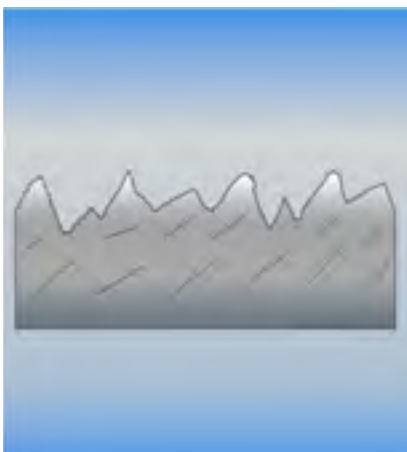

NEW PRODUCTS

WASHROOM ACCESSORIES

Franke Jetstream Airtronic Hand Dryer

The timeless design of the Franke Jetstream Airtronic Hand Dryer, lends itself to the contemporary decor of heavily frequented washrooms.

The touch free electronic warm air hand dryer has a drying time within 15 seconds, with an air speed at 90 meters per second; the exit air temperature is 55 degrees Celsius.

The Jetstream offers users up to 80% energy saving when compared to traditional hand dryers.

Product Code: 359989



Rondo WM Wash Hand Basin

Franke Rondo WM Wash Hand Basin manufactured from Grade 304 (18/10) Stainless Steel, 1,2mm gauge Back Plate. Basin to be fitted with a C.P. Brass 40mm waste fitting and secured to the wall using 6mm anchor bolts.

The rounded feature is unique and ideally suited for public oblations where sharp corners should be avoided.

Product Code: 362964

Protronic-S AQUA 130

Protronic-S mains-dependant, opto electrically-controlled wash basin mixer DN15 with theft-proof aerator with integrated flow rate regulator.

Hands-free wash basin mixer with battery operation

Product Code: 359746

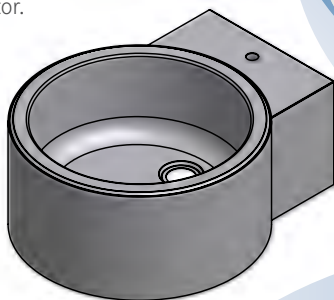

Cistern Back Rail CNTXBR

Grab rail with FFG-surface (Franke Fine Grip) manufactured from 18/10 Stainless Steel to suit cistern installation. Diameter 32mm; certified. Screws and dowels are included.

Product Code: 359912



NEW PRODUCTS

SANITARYWARE

Franke Estonia HD Soft-closing Toilet Seat with Security Fitting

To compliment the new range of WC Pans, Franke have launched the Estonia soft-closing toilet seat. The Franke Estonia Self-closing Toilet Seat is a heavy duty toilet seat with lid manufactured from heavy duty Duroplast material. The toilet seat is manufactured with burn resistance, scratch resistance, cleaning friendly and chemical resistance properties. The vandal resistant mounting hinge is fitted prior to the WC Pan being mounted to the wall, preventing any tampering or theft of the toilet seat.

The seat is available in black or white.



Vandal resistant mounting hinge. The vandal resistant mounting hinge can be fitted to newly manufactured WC Pans or it can be retrofitted to most WC Pans.



Newly manufactured WC Pans will be pre-drilled to position the vandal resistant mounting in the perfect position. The holes for the mounting hinge can also be drilled at a later stage however it is easier when predrilled.



The mounting hinge has to be mounted and secured onto the WC pan before the WC is mounted to the wall. The mounting hinges are manufactured in such a way that they have a 360 degree adjustment.

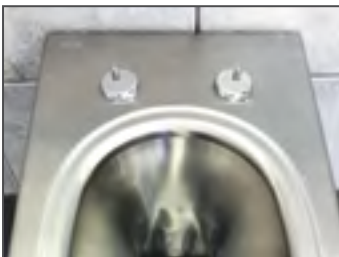

Use the toilet seat to position the hinges and lock them in place. Once the mounting hinges are secured place the chrome caps over the mounting hinges to cover the fitting.



When positioning the toilet seat make sure to check the labels indicating the left and right hand side of the toilet seat. The left hand side is on the left when standing in front of the WC Pan.



Position the toilet seat on the mounting hinges when the toilet seat is in the open position. Firmly press down on the hinges making sure they are in position. Close the toilet seat making sure not to lift the toilet seat out of position.

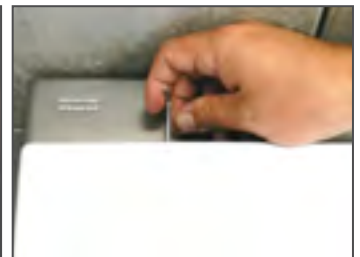

Lock the toilet seat onto the mounting hinges using the Alan Key supplied with the mounting hinges.



By simply lowering the Self-closing Toilet Seat slightly, the toilet seat will continue to close softly and slowly, unaided.

The same applies to the lid of the toilet seat.

Product Code:

Black: 356258

White: 356255

NEW PRODUCTS

SECURITY PRODUCTS

Combination Recessed Drinking Fountain & Wash Hand Basin



Franke Combination Wash Hand Basin & Drinking Fountain, 350mmx465mm. Unit to be manufactured from Grade 304 (18/10) Stainless Steel, 1,2mm gauge. Unit to be manufactured as a welded construction. Unit to be recessed 175mm into the wall with a 40mm concealed waste outlet. Basin to be fitted with a self closing metering bib tap at the top of the unit with fixing lugs to secure the basin into the wall. Unit to be supplied with a Walcro 101 metering tap.

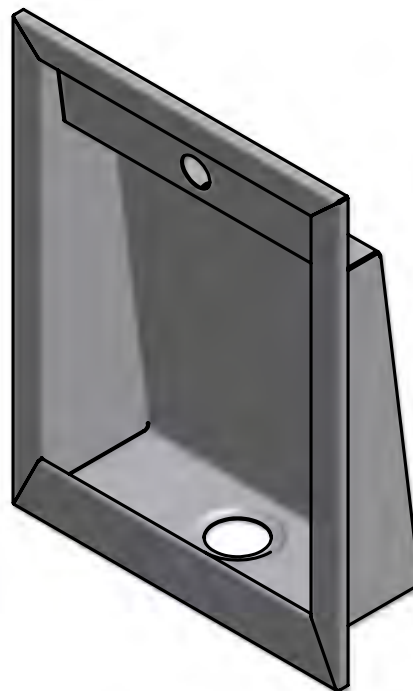

SAPX597 Wall and Floor Mounted WC Pan

Franke SAPX597 vandal proof WC Pan manufactured from 1.2mm Grade 304 (18/10) stainless steel, fully welded and polished to a no. 4 satin finish. Length: 485mm, Width: 390mm, H: 435mm with circular flushing rim & bowl, full flow P-trap, 38mm Ø supply flush pipe: both with sufficient length to protrude through the wall. (All connections to be outside). Integral 35mm wide fixing flange to bottom sides and top, 7 times bolted to wall & floor complete with expanded metal mesh for mechanical bond for plaster/screed to the pan flange. Required pipe length to be determined on site.

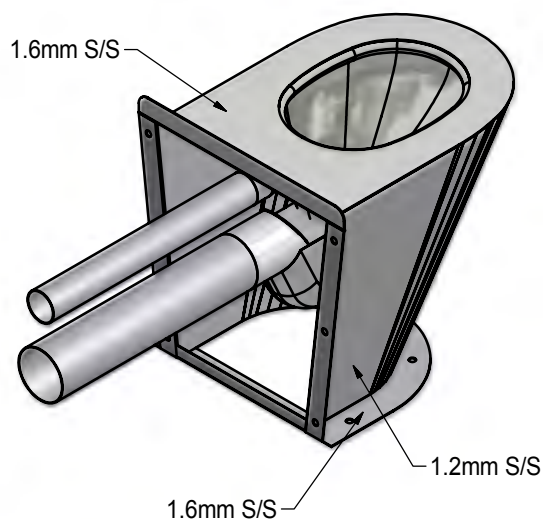

NEW PRODUCTS

HOSPITAL PRODUCTS

Slop Hopper with Stainless Steel "P" Trap - New Option



Franke model CH Slop Hopper 540x540 manufactured from grade 304 (18/10) stainless steel 1,2mm thick with a 100mm high integral splash back to the rear and both sides. The cone has an integral flushing rim and a 110mm waste outlet for pan connector, the inlet is fitted with a 38x250mm long vertical flush pipe for a standard flush valve. Unit fitted with a hinged bucket grid manufactured from 10mm diameter grade 304 (18/10) stainless steel round bar complete with two 40x40mm square stainless steel wall mounting gallowes brackets. Unit fixed to wall 600mm from the top of the front apron to the finish floor level with 4 off anchor bolts (bolts specified elsewhere).

STANDARD FLUSHING METHOD USING FLUSH VALVE METHODS:

Cobra model FM 1.000 - 35mm water supply flush valve or, Cobra FJ 2.000 - 20mm water supply flush valve and a . . . Cobra FJT 1.2 straight flush pipe connected to CP on brass adaptor (Flush valves specified elsewhere)

ALTERNATIVE FLUSHING METHOD USING HIGH LEVEL CISTERN:

Slop Hopper can be adapted to flush using 11 litres stainless steel high level cistern fitted with Supa Flush Valve and pull chain, 41mm diameter stainless steel flush pipe and 41mm chrome plated coupling which is reduced on one end to fit the 38mm connection on the unit.

Slop Hopper Optional Extras:



Removable Grid

Product Code: 354952

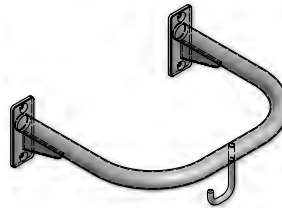

Tap Bracket

To fit over flush valve for protection with bucket hook.

Product Code: 354952

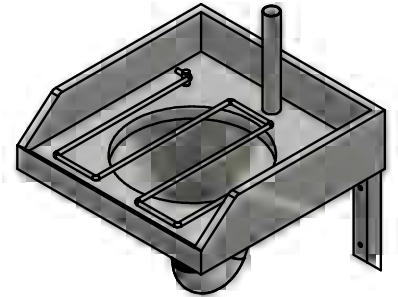

NEW PRODUCTS

SMS Surgeon Mini Scrub-up Unit with square edges

Franke model SMS surgeon scrub-up unit, size 665x554x258mm deep manufactured from grade 304 (18/10) stainless steel 1,6mm thick complete an integral splash back 300mm high with tap holes for a medical elbow action mixer. Unit with a pressed bowl 525x425x258mm deep manufactured from grade 304 (18/10) stainless steel 0.9mm thick with a 90mm waste outlet for a basket strainer fitting (included with unit). Unit fitted with removable galvanised mild steel 1,6mm thick fixing plate. Unit fixed to wall 900mm high from the top of the front apron to the finish floor level with anchor bolts (bolts specified elsewhere).

The model has been modified and simplified to include squared edges and corners around the bowl as apposed to the previous rounded edge model.

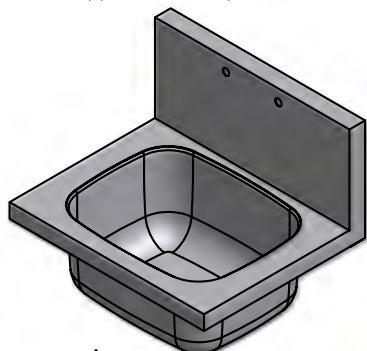

New design with square edges



Old design with rounded edges

NEW PRODUCTS

MORTUARY PRODUCTS

Franke have a reputation for the design and manufacturing of high quality stainless steel washroom and hospital equipment. Franke are now offering services to the field of mortuary medical equipment in providing a total design and manufacture service of autopsy tables, body storage racks, body trays and transport trolleys. Our services include an in-house INVENTOR 3D design facility, enabling us to provide a complete service from concept to design to manufacture and supply of completed products.



Autopsy Table

Franke model KZ Autopsy table is pedestal style table that is ergonomically designed to facilitate free operator movement when using the table. The table is manufactured in grade 316 stainless steel with integrally constructed bowl and is supplied complete with all the plumbing fittings and is fitted with a 110mm waste outlet with a removable standing overflow.

Design Features:

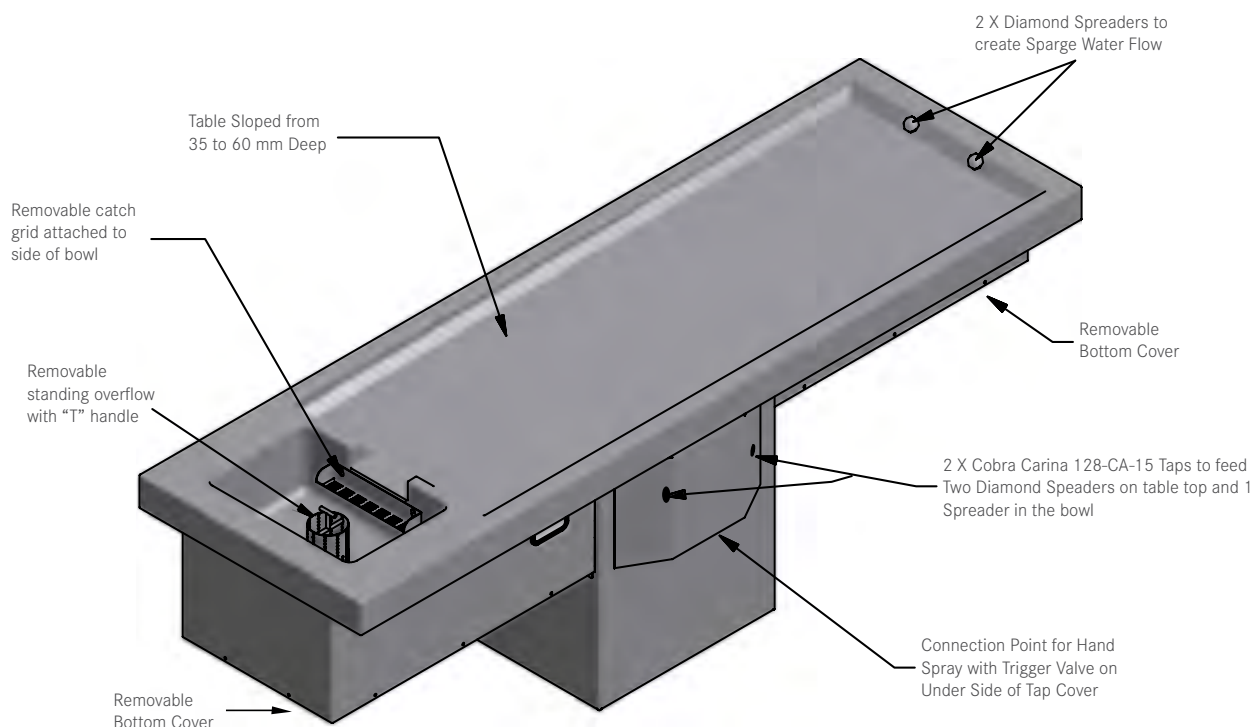

Elevated View

NEW PRODUCTS

MORTUARY PRODUCTS

Body Racks

Standard and Obese Body Racks

Body Racks are manufactured to comply with the standard mortuary design specification and dimensions, the struts and main bearers are fabricated from 40 x 40 x 1, 5 mm thick stainless steel square tubing and the stays and roller supports are 3 mm thick 304 stainless steel. The rollers are nylon and rollers shafts and rods are 16 mm diameter grade 304 stainless steel.

The racks are designed to add additional roller shaft assemblies and bearers to extend the racking to accommodate additional body trays (banks of 2, 3 etc.).



Transport Trolleys & Body Trays

This is an essential part of the post-mortem laboratory and in the hospital the transport and hydraulic lifting trolleys are designed to transport the body from cold chamber racks to display trolley or autopsy table.

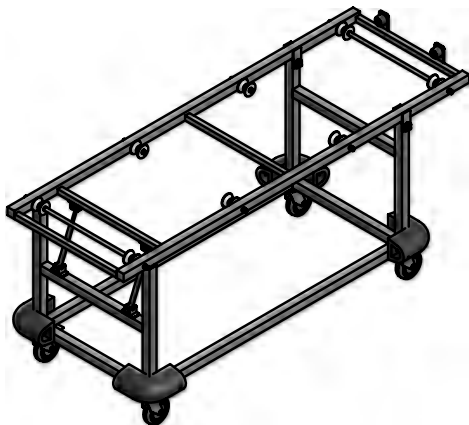

Franke Model TT Transport Trolley

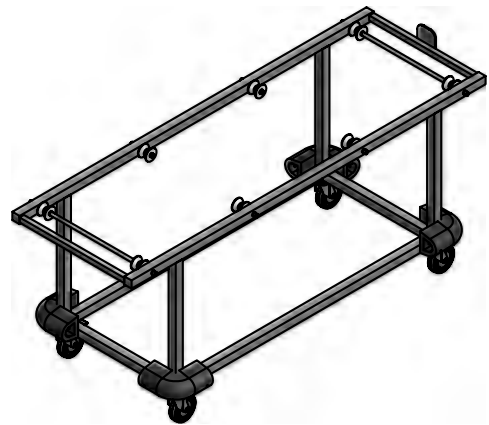

Franke Model TLT Tilting Trolley

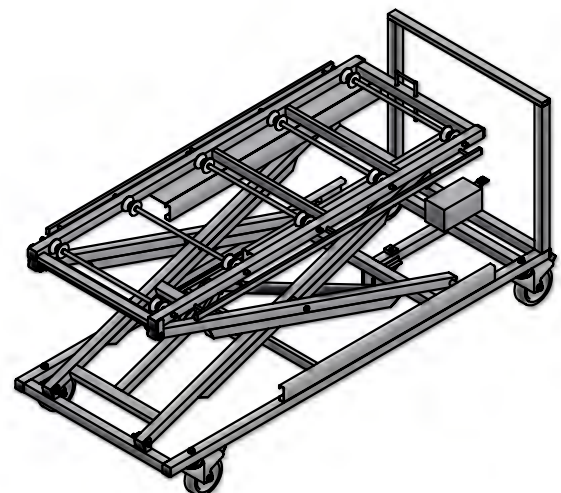
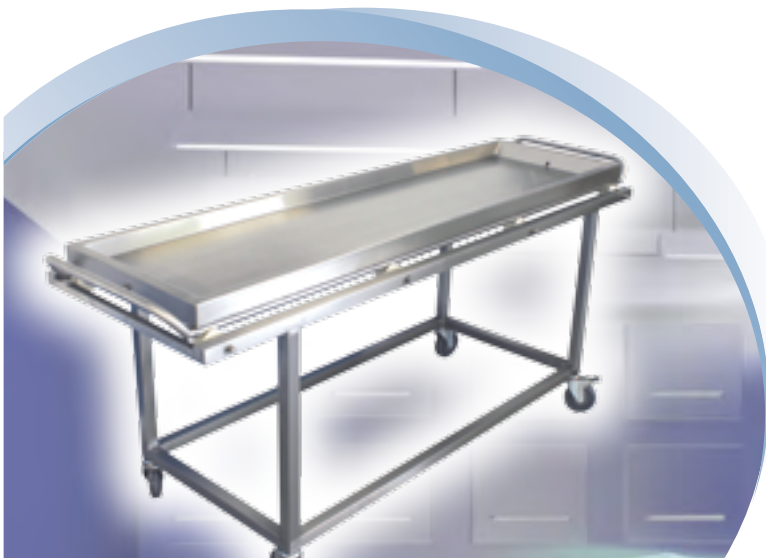

Franke Model ET Elevation Trolley

Able to raise up to ± 1.85 Meters High

NEW PRODUCTS

DEKO DISINFECTION UNITS

DEKO 190



DEKO 190 has a large wash chamber and capacity for automatic emptying and **processing of 2 bedpans with lids and 4 urine bottles simultaneously**. The integrated drop down shelf provides space for 4 hand wash basins or a mop bucket with seating ring.

The shelf can also be utilised as a base to accommodate and process inserts and washing accessories e.g. kidney dishes, bowls, vases, toilet brushes/holders, as well as, various hollow ware.

DEKO 190 Base Model

355011

Specifications

DEKO Model 190 Bedpan washer, 630 x 600 x 1290mm, manufactured from Grade 304 stainless steel with an internal washing chamber no less than 480 x 360 x 340 mm. The Bedpan washer has the ability, but is not limited to, washing a maximum of 2 bedpans with lids and 4 urine bottles in a single cycle. The unit to be fitted with adjustable feet and to be freestanding with a front loading door that prevents spillage. The outlet diameter must be 110mm and the unit is to comply with the ISO 15883 specification. The Bedpan washer must have a built in tank for the recirculation of water with a pump of no less than 600l per minute to compensate for any drop in incoming water pressure. Unit to be manufactured with no less than 3 rotating and 8 fixed wash jets. Contact 0861372653

DEKO 260



The DEKO 260 washer-disinfector - is designed and manufactured to be fully compliant with the requirements of ISO EN 15883 Parts 1 & 2. It builds on the already well proven reliability and simple operation synonymous with Franke and ensures thorough cleaning and efficient processing of reusable medical and laboratory equipment.

DEKO 260 Base Model

355005

Specifications

DEKO Model 260 instrument washer disinfector, 650 x 625 x 1850 mm, manufactured from Grade 304 stainless steel with an internal washing chamber no less than 507 x 507 x 485 mm. The unit will be fitted with adjustable feet and be freestanding. The Instrument washer must comply with the ISO 15883-1, 15883-2 specification and shall have a built in circulation pump of no less than 700l per minute to compensate for any drop in incoming water pressure. Interlocking front-opening door with safety lock. Contact 0861372653.

Deko Service plans and verification tests are in line with CEE mark

Franke offers a one to three year service plan as an optional extra with the sale of all new Deko machines. Franke also offers after market service plans or just routine servicing and maintenance. Verification testing in line with the CE mark is also available ensuring that your Deko machines always stay upto date and that they comply with all the necessary regulations. Deko machines are manufactured to comply with the ISO 15883 and regular verification testing will ensure that the Deko machines maintain this grade.

NEW PRODUCTS

ZIP

Zip HydroTap® Miniboil® Elite

Super-compact economy model for filtered boiling water and filtered ambient water



Features

- Super-compact, super-simple instant boiling water system for home kitchens.
- Press the red touch pad and safety lock together for filtered boiling water instantly.
- No more waiting for water to boil for tea, coffee and cooking.
- Press the blue touch pad for filtered ambient water, instantly. Great tasting freshly filtered water for cool drinks and cooking.
- Permanent safety lock requires two finger operation to access boiling water.
- Temperature status indicator light signals when boiling water is ready to use.
- Filter warning light signals when the water filter cartridge replacement is due.

Super compact under sink unit with external filter system

- Makes it easy to install where sink cupboard space is limited.
- PLUS internal boiling water pump for steady continuous flow.
- Water dispenses at set temperature from the first drop. No waste.
- PLUS cool touch tap head and body.

Superior triple action sub-micron filtration ensures crystal clear, great tasting, healthier water

- 1) Removes impurities smaller than one thousandth of a millimetre, including Cryptosporidium and Giardia. Reduces dirt, rust, asbestos fibres and other suspended impurities.
- 2) Removes chlorine plus other tastes and odours to leave water crystal clear and odourless.
- 3) Reduces common limescale build up inside the tank.

* Available exclusively at Italtile



Miniboil Elite



Touch pad control panel
Nothing could be simpler.

ZIP HYDROBOIL PACKAGING

Late last year, we launched the new Zip HydroBoil packaging. This new packaging fits in with Zip's corporate and brand identity.

At its core the packaging illustrates the ease of use of the product and how it easily and functionally blends into any environment.



2.5L Zip HydroBoil



10L Zip HydroBoil



Front



Back

5 / 7.5L Zip HydroBoil



Original HydroBoil Packaging



Zip®

FRANKE 2013 PRODUCT GUIDES

All product guides can be downloaded from www.franke.com

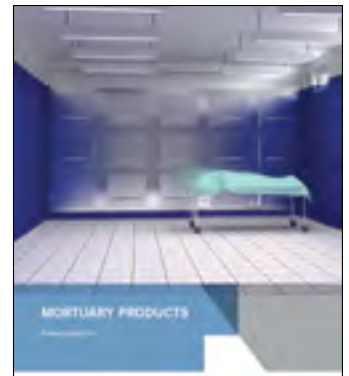
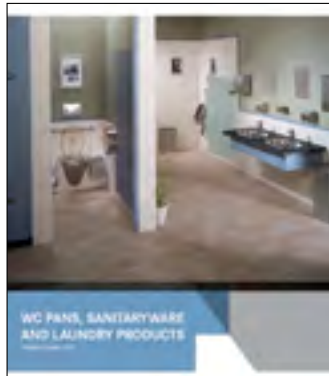

PROFESSIONAL
ASSOCIATIONS

FRANKE PROFESSIONAL ASSOCIATIONS

WE ARE MEMBERS OF AND AFFILIATED TO:



FRANKE KITCHEN SYSTEMS (PTY) LTD

CALL CENTRE

Tel 0861 372 653

Fax +27 31 450 6302

enquiry.fsa@franke.com

www.franke.com

DURBAN

1194 South Coast Road,

Mobeni, Durban, 4092.

South Africa

Tel +27 31 450 6300

Fax +27 31 450 6303

GAUTENG

77 Roan Crescent,

Sage Corporate Park North,

Old Johannesburg Road,

Midrand, 1682

South Africa

CAPE TOWN

Unit 29, Gold Street,

Northgate Business Park, Northgate Estate,

Cape Town, 7405

South Africa

DISCLAIMER

The information and data supplied in this brochure is based on information believed to be reliable, however it is not binding and inaccuracies may occur. Franke reserves the right to change specifications and design at any time without notice.

© 2012 by Franke Kitchen Systems (Pty) Ltd. All rights reserved under the Copyright Act of 1987 with amendments. Reproduction of any of the content, full or partial, is allowed only with the prior written approval of Franke Kitchen Systems (Pty) Ltd. No reasonable requests will be refused provided conditions as laid out are met.

All information provided in this brochure is for informational purposes only. All information, text, technical drawings and images are the exclusive property of Franke. The content herein may not be reproduced in whole or part. Any use of the content without written permission from Franke is prohibited.



WASHROOM
SYSTEMS