LAUNDRY PRODUCTS



Laundries are subject to heavy usage and a comprehensive range of products are available to meet the criteria of aesthetics, functionality and application.

The range of products cover various sectors of the industry varying from residential to industrial and public facilities.

Most laundry products are externally used and exposed to the elements and sunlight. Stainless Steel is highly resistant to deterioration in these applications.

Various Designs for Different Applications

- Suitable for a variety of environments
- Selection of washtroughs and laundry products

DLT LUXTUB - INSET TYPE WASH TROUGH



FITTING NOT INCLUDED

FEATURES:

- Grade 304 (18/10) Stainless Steel, 0,9mm gauge
- Inset type for fitting to worktop
- One piece pressed bowl 43 litres

Product Code: 318650

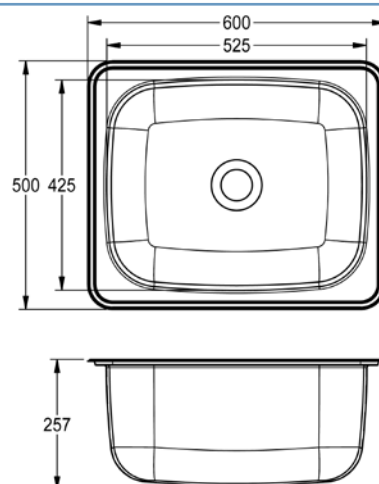

SPECIFICATION:

Franke Model DLT Inset Wash Trough 600x500x257mm. Unit to be manufactured from Grade 304 (18/10) Stainless Steel, 0,9mm gauge. Unit to include a pressed bowl 525x425x257mm deep (43 litres) with a 40mm waste outlet. Unit to be fitted into the worktop, cut out size 535x435mm (worktop elsewhere measured).

LDL LUX TUB - WALL MOUNTED/DROP-ON WASH TROUGH



FEATURES:

- Grade 304 (18/10) Stainless Steel, 0,9mm gauge
- Trough wall mounted or drop on type
- One piece pressed bowl 43 litres

Product Code: 318600

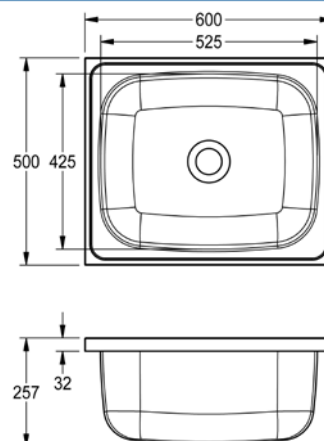

SPECIFICATION:

Franke Model LDL Drop-on Wash Trough 600x500x257mm. Unit to be manufactured from Grade 304 (18/10) Stainless Steel, 0,9mm gauge. Unit to include a pressed bowl 525x425x257mm deep (43 litres) with a 40mm waste outlet. Unit to be fixed to the wall with a pair of galvanised mild steel Falcon Brackets (brackets optional, please specify).

Please refer to fixing table (Page 38).

SIRX WASH TROUGH (INSET OR WALL MOUNTED TYPE)

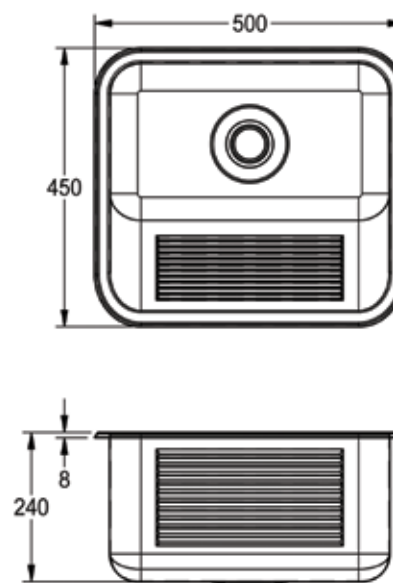

FEATURES:

- Grade 304 (18/10) Stainless Steel, 1,2mm gauge
- Inset type for fitting to unit top or suitable for bracket fixing.
- Slanted ribbed front for scrubbing
- Pressed bowl with radiused corners

Product Code: 318619

SPECIFICATION:

INSET TYPE

Franke Model SIRX342 Wash trough, 500x450x240mm deep. Unit to be manufactured from Grade 304(18/10) Stainless Steel, 1,2mm gauge. Unit to be fitted into the worktop (worktop elsewhere measured).

WALL MOUNTED

Franke Model SIRX342 Wash trough, 500x450x240mm deep. Unit to be manufactured from Grade 304(18/10) Stainless Steel, 1,2mm gauge. Unit to be fixed to the wall with a pair of Stainless Steel wall fixing brackets (brackets optional, please specify).

Please refer to fixing below

OPTIONAL:

WALL FIXING BRACKETS FOR SIRX WASH TROUGHS

Wall fixing brackets to be manufactured from Grade 304 (18/10) Stainless Steel, 1,2mm thick.

Product Code: 300367

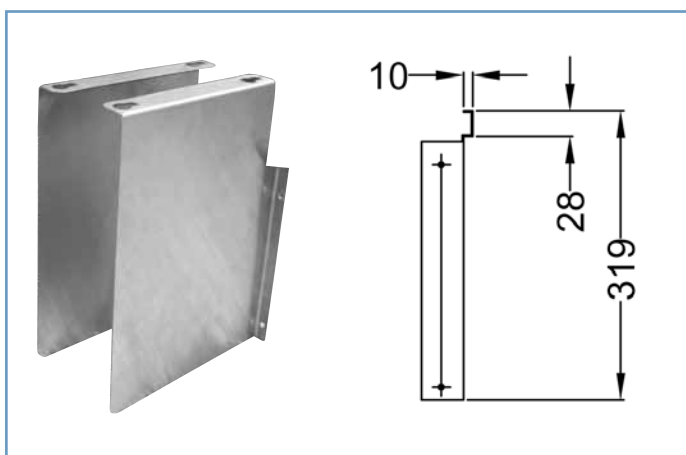

RANGES OF SIRX WASH TROUGHS

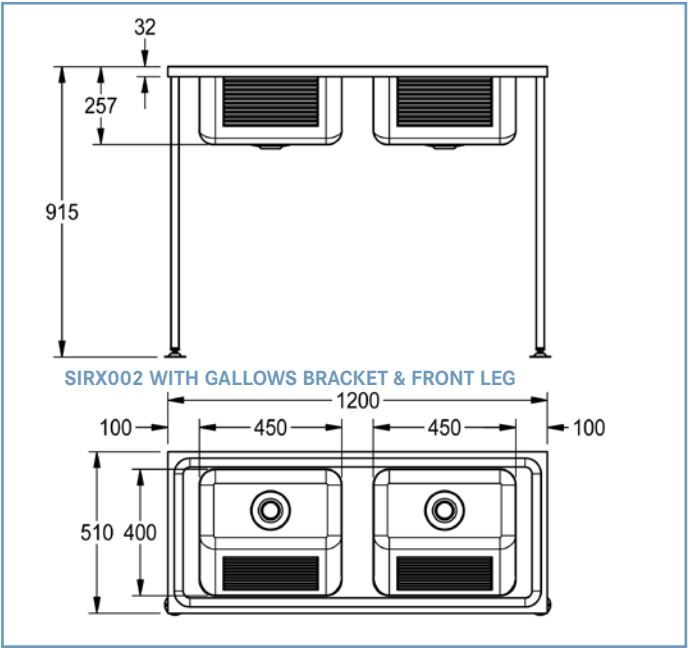
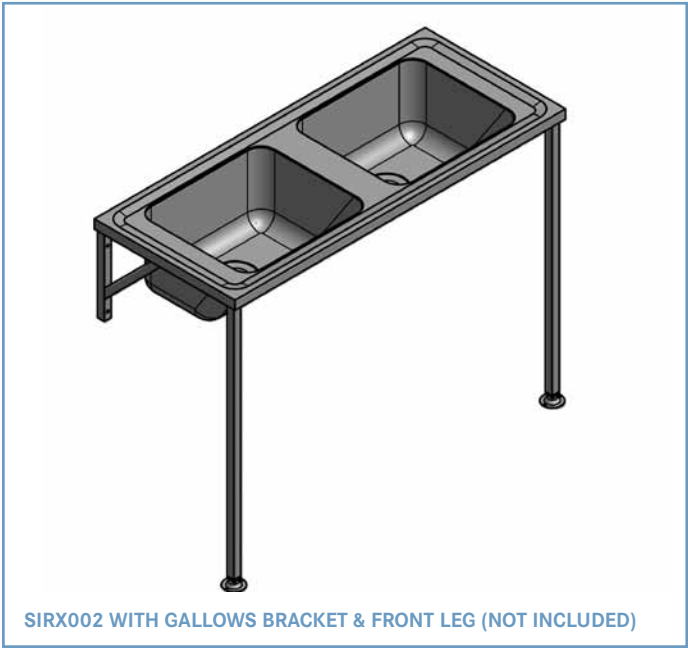

FEATURES:

- Grade 304 (18/10) Stainless Steel, 1,2mm gauge
- Inset type for fitting to unit top or suitable for bracket fixing.
- Slanted ribbed front for scrubbing
- Pressed bowl with radiused corners

SPECIFICATION:

Franke Model SIRX...(please specify) range of Wash Troughs. Unit to be manufactured from Grade 304 (18/10) Stainless Steel, 1,2mm gauge. With pressed bowls 500x450x240mm deep (43 litres) with a 40mm waste outlet.

Unit to be fixed as follows (please specify):

- Fixed to wall on two 25mm square mild steel galvanised or Stainless Steel galloWS brackets
- Fixed to wall and floor on two 25mm square mild steel galvanised or Stainless Steel galloWS brackets with front legs and adjustable foot piece height 915mm from finished floor level

Please refer to fixing table. (Page 38)

PRODUCT CODE	MODEL	NO. OF BOWLS	EXTERNAL LENGTH MM	EXTERNAL WIDTH MM	BOWL DEPTH MM
357004	SIRX002	2	1200mm	510mm	257mm
357002	SIRX003	3	1800mm	510mm	257mm

FIXING BRACKETS

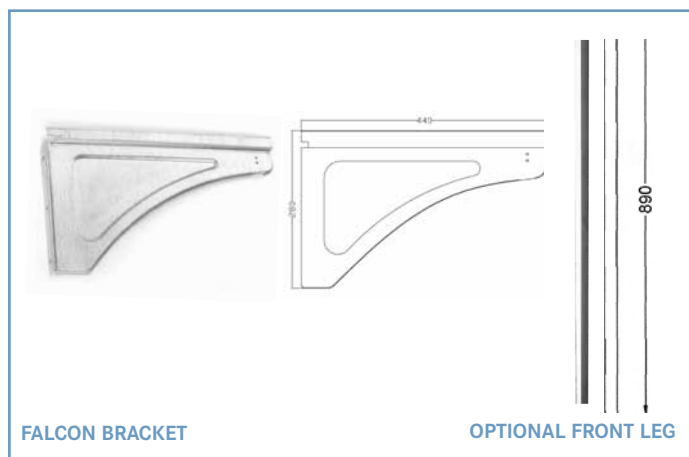

FALCON BRACKET FOR WASHTROUGHS

Falcon Brackets (Patent No.95/4163)

Wall fixing brackets 440x280 to be manufactured from galvanised mild steel.

Product Code: 300322

Optional: Bolt on leg to be manufactured from electro polished 25mm square mild steel tubing with an adjustable foot and floor fixing flange.

Product Code: 300065

Suitable for LDL Washtrough only.

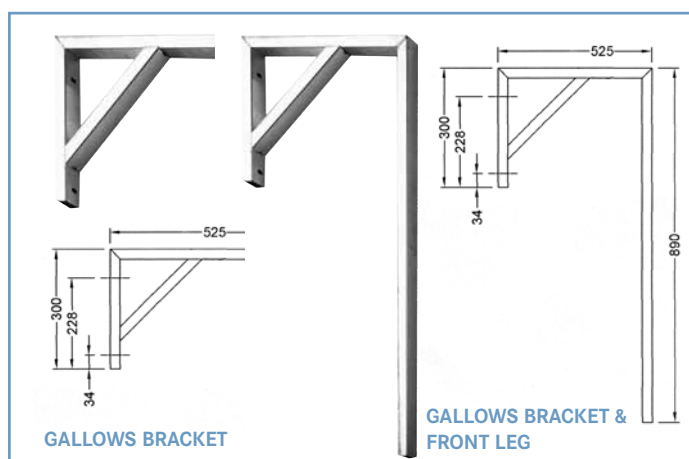

GALLOWS BRACKETS & LEGS FOR RANGES OF BASINS, WASHTROUGHS AND BLANKET WASH TROUGH.

Gallows Brackets - Galvanised Mild steel

Gallows brackets to be manufactured from electro-galvanised 25mm square mild steel tubing

Product Code: 300365

Gallows Brackets - Stainless Steel

Gallows brackets to be manufactured from 25mm square Stainless Steel tubing

Product Code: 300361

Gallows Brackets and Front Legs - Galvanised Mild steel

Gallows brackets and front legs to be manufactured from electro-galvanised 25mm square mild steel tubing

Product Code: 300364

Gallows Brackets and Front Legs - Stainless Steel

Gallows brackets and front legs to be manufactured from 25mm square Stainless Steel tubing

Product Code: 300363

ET 101 FABRICATED SINGLE WASH TROUGH

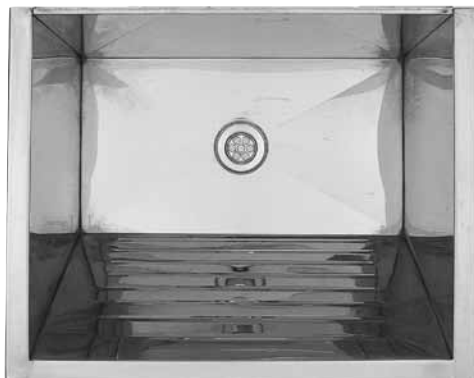

FITTING NOT INCLUDED

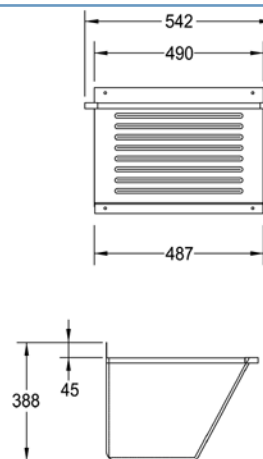

FEATURES:

- Manufactured from Grade 430 (17/10) Stainless Steel
- Suitable for light purpose applications
- Supplied with fixing lugs for wall mounting

Product Code : 320811

***Note:** The economy type wash troughs are not recommended for coastal, heavy duty or severe corrosive applications. Refer to Luxtub models for these applications.

SPECIFICATION:

Franke Model ET101 Single Fabricated Economy Type Wash Trough, 542x440x388mm deep. Unit to be manufactured from Grade 430 (17/10) Stainless Steel, 0,8mm gauge. Unit to be manufactured with a sloped front, with wash ridges and a 40mm waste outlet. Trough to be supplied with fixing lugs to mount the trough to the wall. (Bolts elsewhere measured)

ET 102 FABRICATED DOUBLE WASH TROUGH

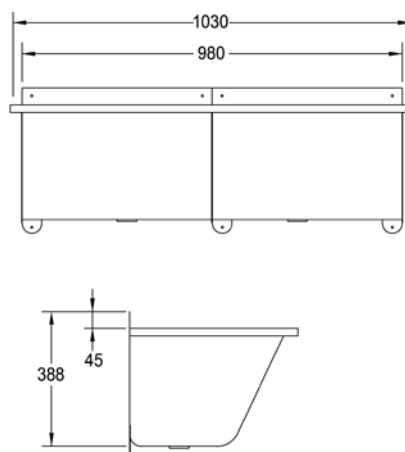

FEATURES:

- Manufactured from Grade 430 (17/10) Stainless Steel
- Suitable for light purpose applications
- Supplied with fixing lugs for wall mounting

Product Code: 320200

***Note:** The economy type wash troughs are not recommended for coastal, heavy duty or severe corrosive applications. Refer to Luxtub models for these applications.

SPECIFICATION:

Franke Model ET102 Double Fabricated Economy Type Wash Trough, 1030x440x388mm deep. Unit to be manufactured from Grade 430 (17/10) Stainless Steel, 0,8mm gauge. Unit to be manufactured with a sloped front, with wash ridges and a 40mm waste outlet. Trough to be supplied with fixing lugs to mount the trough to the wall. (Bolts elsewhere measured)

ET103 FABRICATED MINI WASHTROUGH

Suitable for Low Cost Housing Projects



FITTING NOT INCLUDED

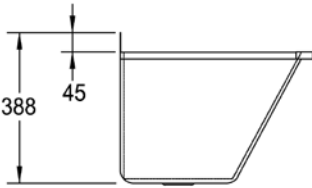
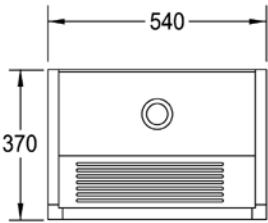

FEATURES:

- Manufactured from Grade 430 (17 / 10) Stainless Steel
- Suitable for light purpose applications
- Suitable for low cost housing projects
- Supplied with fixing lugs for wall mounting

Product Code : 320920

SPECIFICATION:

Franke Model ET103 Mini Single Fabricated Economy Type Wash Trough, 540x370x388mm deep. Unit to be manufactured from Grade 430 (17 / 10) Stainless Steel, 0,8mm gauge. Unit to be manufactured with a sloped front, with wash ridges and a 40mm waste outlet. Trough to be supplied with fixing lugs to mount the trough to the wall. (Bolts elsewhere measured)

***Note:** The economy type wash troughs are not recommended for coastal, heavy duty or severe corrosive applications. Refer to Luxtub models for these applications.

HRT HALF ROUND WASH TROUGH

Designed for Public Ablutions, Schools, Abattoirs and Hostels

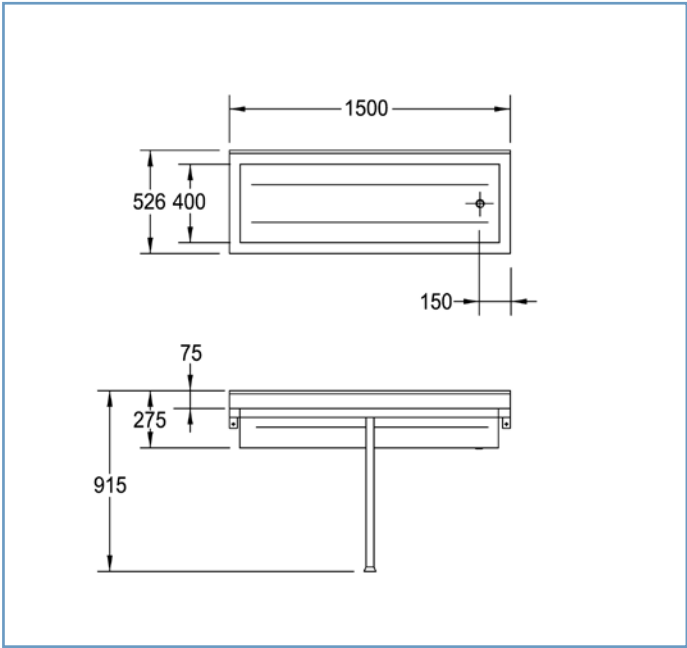

FEATURES:

- Manufactured from Grade 304 (18/10) Stainless Steel, 1,2mm gauge
- One 40mm waste outlet minimising plumbing costs
- 75mm high splash back

SPECIFICATION:

Franke Model HRT Half Round Wash Trough, length...(please specify) x 510mm. Unit to be manufactured from Grade 304 (18/10) Stainless Steel, 1,2mm gauge. Unit to be supplied with a 75mm high splash back and tiling key to the back and both ends, with one 40mm waste outlet on left or right hand side ...(please specify). Unit to be mounted on 40x40mm galvanised mild steel square tubing framework, with 100x40x30mm galvanised mild steel flat section cleats welded to back and sides for fixing to walls. Unit to be manufactured complete with one front leg with chrome plated adjustable foot piece.

PRODUCT CODE	MODEL	LENGTH MM	WIDTH MM	OUTLET
359400	HRT	1500mm	510mm	Left Hand Side
359412	HRT	1500mm	510mm	Right Hand
359406	HRT	1800mm	510mm	Left Hand Side
359414	HRT	1800mm	510mm	Right Hand

* Please Note
** Non Standard sizes available on request
** Maximum length not to exceed 2500mm
** Lengths >2500mm to be manufactured as separate units.

BWT BLANKET WASH TROUGH

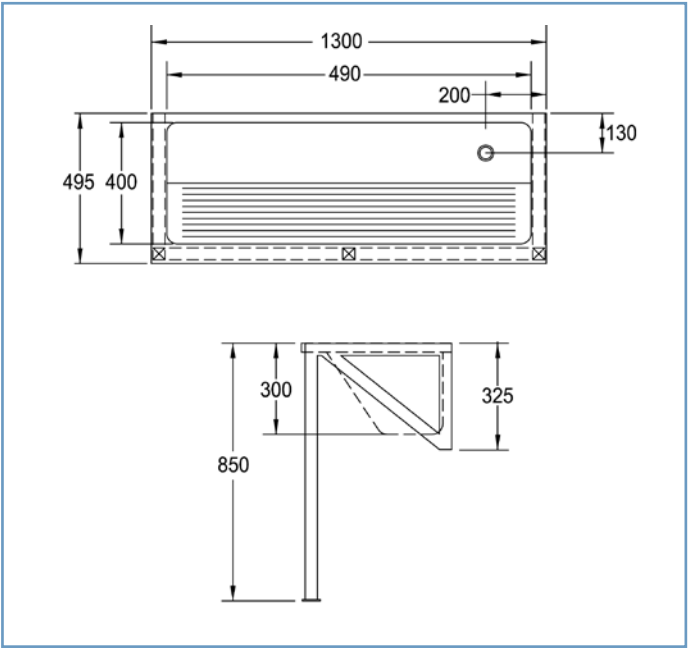

FEATURES:

- Manufactured from Grade 304 (18/10) Stainless Steel 1,2mm gauge
- One 40mm waste outlet minimising plumbing costs
- Supplied with gallows brackets and front legs

Product Code: 357040

SPECIFICATION:

Franke Model BWT Blanket Wash Trough, 1300x495x300mm. Unit to be manufactured from Grade 304 (18/10) Stainless Steel, 1,2mm gauge. Radiused internal corners and sloped front, with 40mm waste outlet. Unit to be supplied complete with two Stainless Steel gallows brackets with front legs.