



Smart PLUS 2

Overhead door closers





Smart **PLUS2**

Overhead door closers

Smart PLUS2 is a range of high quality door closers by CISA, ideal for standard door control and all applications that require the very best in reliability and durability.



DOOR CLOSER WITH COVER

The compact design features a plastic cover whose rounded, eye-catching shape blends in with any environment.

QUALITY/PRICE

The excellent quality/price ratio, together with the reliability of CISA products, makes Smart PLUS2 door closers the perfect choice for all doors.

APPLICATIONS

- Standard doors
- Fire doors 

EASY INSTALLATION

Quick and easy to install thanks to the fixing template. The range has been designed so it is easily interchangeable with both earlier CISA models and other door closers available on the market.

RELIABILITY

The quality of the materials used and the level of precision engineering make CISA Smart PLUS2 door closers long-lasting and reliable.

COMPLIANCE AND MARKING

The materials used and the technical solutions adopted guarantee compliance with the strictest regulatory requirements. This has enabled CISA to obtain marks and certifications including: CE marking in compliance with Regulation (EU) No. 305/2011 issued by EXOVA for use on fire doors.



Arm with hold-open device

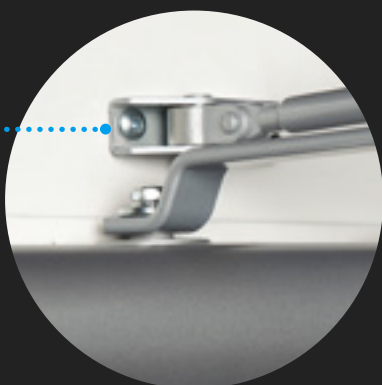

*EN standard force adjusted
by changing the position of the support
(see Installation Instructions)*

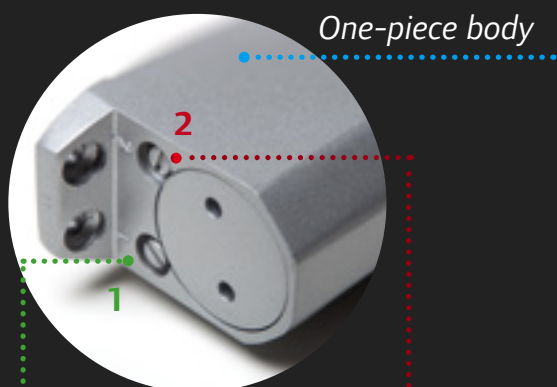

*Closing speed
adjustment valve*

*Final latch
adjustment valve*

TECHNICAL FEATURES

- Steel arm with hold-open device
- One-piece body in pressure die-cast aluminium alloy
- Rack and pinion mechanism in hardened steel for smooth and efficient operation
- Removable ABS cover

ADJUSTMENTS

- Multistrength version adjusted by changing the position of the body and the arm hinge, forces 2 and 3 (EN1154 force), force 3 (CE)
- Separate closing speed and final latch adjustment valves
- Closing speed can be adjusted from 180° to 15° by the relevant valve (1)
- Force of final latch can be adjusted from 15° to 0° by the relevant valve (2)
- Hold-open position can be adjusted up to 130° (cannot be used on fire doors)

FINISHES

Standard



SILVER
(fin. 97)

Optional

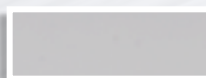

WHITE
(fin. 45)

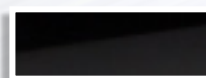

BLACK
(fin. 44)



GOLD
(fin. 87)

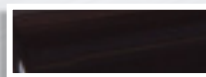

DARK BROWN
(fin. 88)

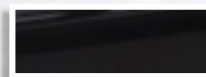

MATT BLACK
(fin. 90)

SmartPLUS2 Overhead door closers



TYPE	CERT.	DESCRIPTION	EN CLOSING FORCE	DOOR WIDTH MM	DOOR WEIGHT KG			ITEM			
						UNIT WEIGHT	PIECES	Type	Dim.	Hand	Fin.
		MULTISTRENGTH <ul style="list-style-type: none"> Without hold-open device CE marked in compliance with 89/106/CEE Directive issued by ICIM 	3	950	60	1,800	1	1 C1415	03	0	97
		MULTISTRENGTH <ul style="list-style-type: none"> With hold-open device on arm 	2÷4	850÷1100	40÷80	1,800	1	1 C1416	03	0	97

SmartPLUS2 Overhead door closers - Installation accessories



TYPE	CERT.	DESCRIPTION			ITEM			
			UNIT WEIGHT	PIECES	Type	Dim.	Hand	Fin.
		<ul style="list-style-type: none"> Arm bracket 	0,230	1	1 07141	01	0	97

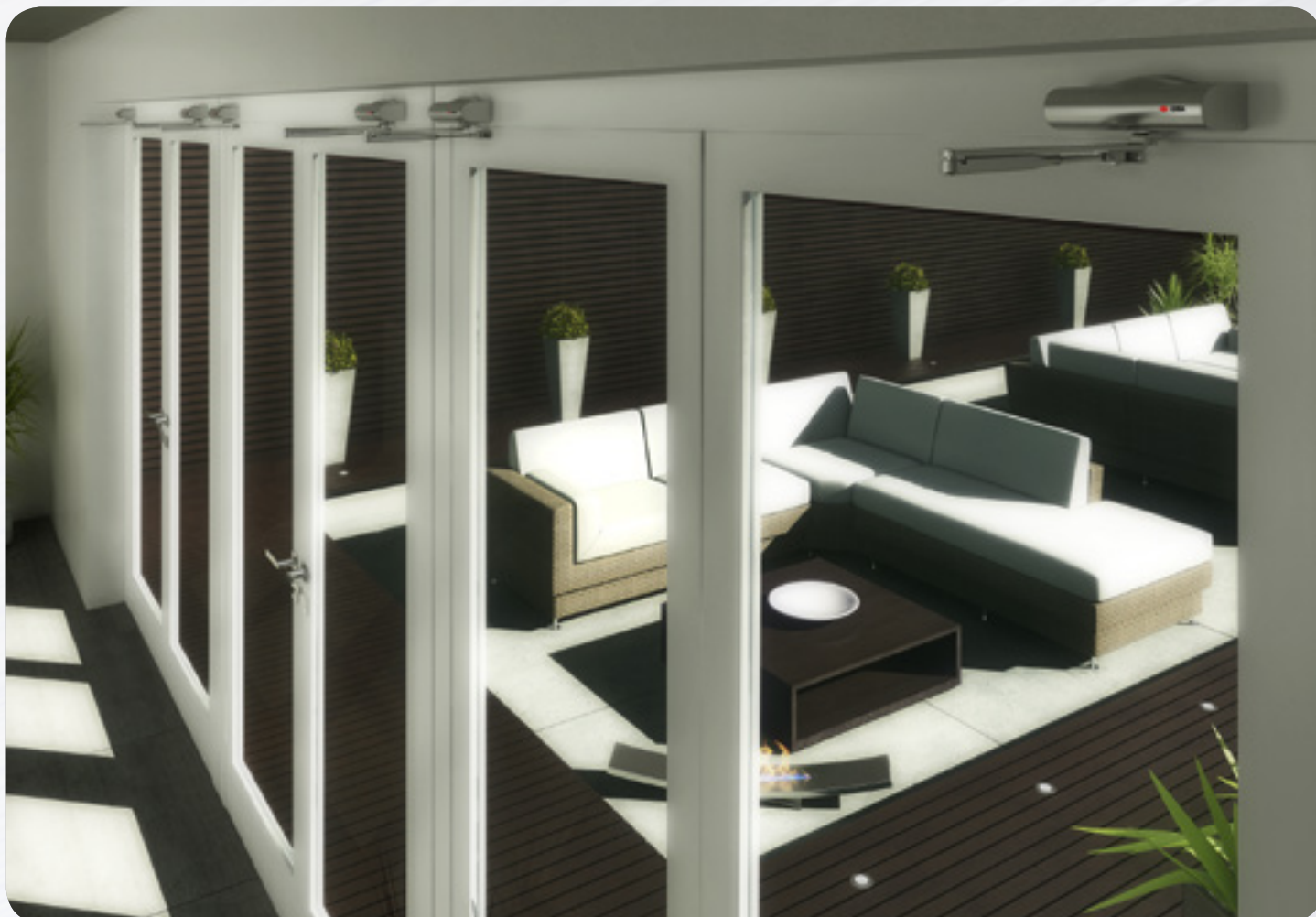

Adjusting strength and maximum door dimensions.

The closer body remains in a fixed position. The closing force of the door is adjusted by changing the position of the arm support.

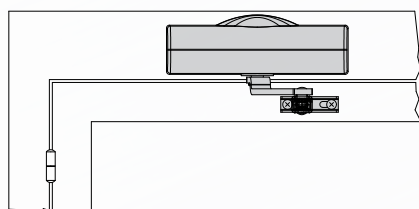
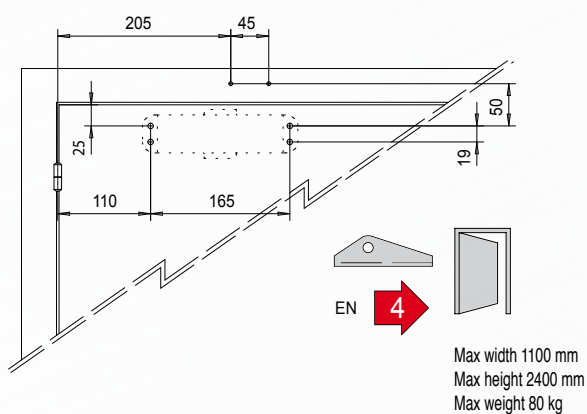
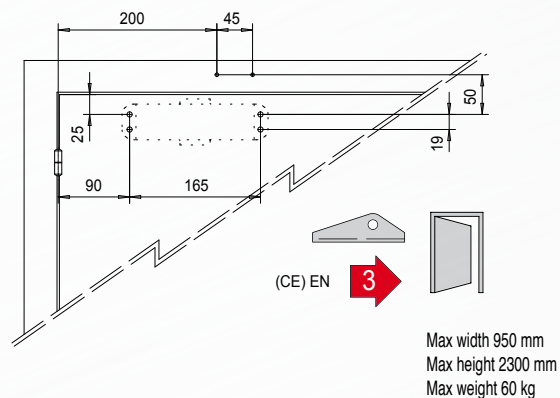
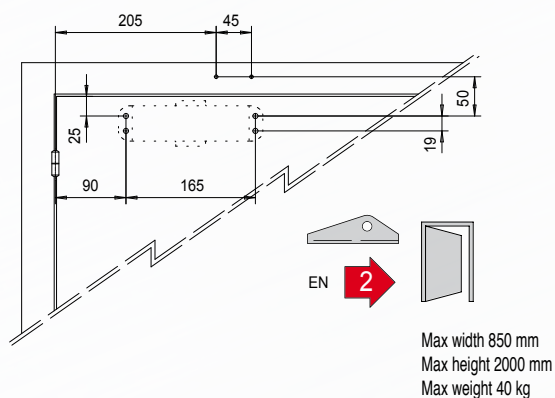

Installation on side opposite hinges,
for doors opening outwards

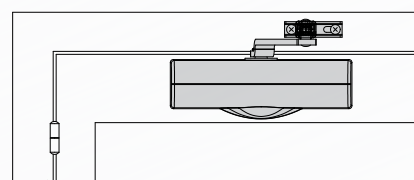

Installation on hinge side

ADJUSTMENTS

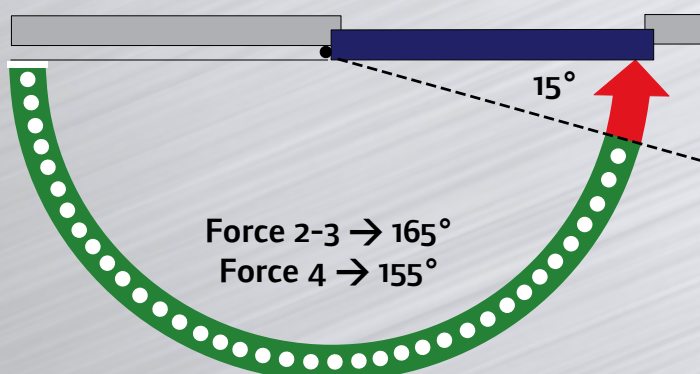

Adjustment sector for final latch (with valve)

Adjustment sector for closing speed (with valve)

Smart **PLUS2**

Examples of installation accessories

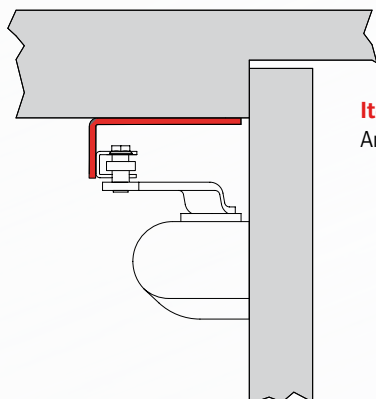

Item 07141 01
Angle bracket

Smart **PLUS2**

Dimensions

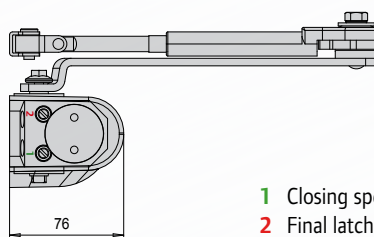
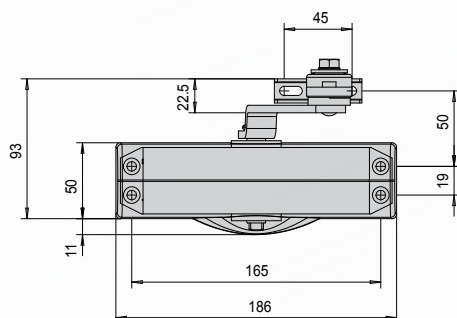

- 1 Closing speed adjustment valve
- 2 Final latch adjustment valve



Watch CISA product tutorials
on YouTube at CISAlocks.



About Allegion

Allegion (NYSE: ALLE) creates peace of mind by pioneering safety and security. As a \$2 billion provider of security solutions for homes and businesses, Allegion employs more than 7,800 people and sells products in more than 120 countries across the world. Allegion comprises 23 global brands, including strategic brands CISA®, Interflex®, LCN®, Schlage® and Von Duprin®.

For more, visit **allegion.com**

