



Post Tower, Bonn

GEZE Patch Fittings



BEWEGUNG MIT SYSTEM

Contents

Patch Fittings Technology	3
GEZE PT 10	4
GEZE PT 20	5
GEZE PT 30	6
GEZE PT 24	7
GEZE PT 40	8
GEZE GK 50	9
GEZE US 50	10
GEZE PL 50	11
GEZE GK 20	12
GEZE PT 63	13
GEZE PT 70	14
GEZE PT 80	14
Product information	15



DOOR TECHNOLOGY



GLASS SYSTEMS



AUTOMATIC DOOR SYSTEMS



RWA AND VENTILATION TECHNOLOGY



SAFETY TECHNOLOGY

Total glass door solutions

The GEZE Patch Fittings for all-glass elements in toughened and laminated safety glass are characteristic in their simple elegance resulting from a reduction to the essentials. The fittings appear nearly flat on the glass surface, thus accentuating the delicate style. All visible parts of the patch fittings are made of stainless steel, featuring clearly defined shapes on smooth surfaces.

The patch fittings are a consequent completion of the GEZE product range, starting from the floor spring to the upper pivots.

Apart from its elegant styling, the GEZE Patch Fittings system offers many advantages to its user. The core of the system consists of one fixing point consisting of an internal tapered thread barrel and two threaded flanges, thereby forming the primary connection between the fitting and glass.

The structural link of the fitting to the fixing points is afforded via fixing screws and fitting plates. The whole range of fittings is based on this fundamental concept. This design simplifies handling the glass as well as it is a prerequisite for the application with laminated safety glass.

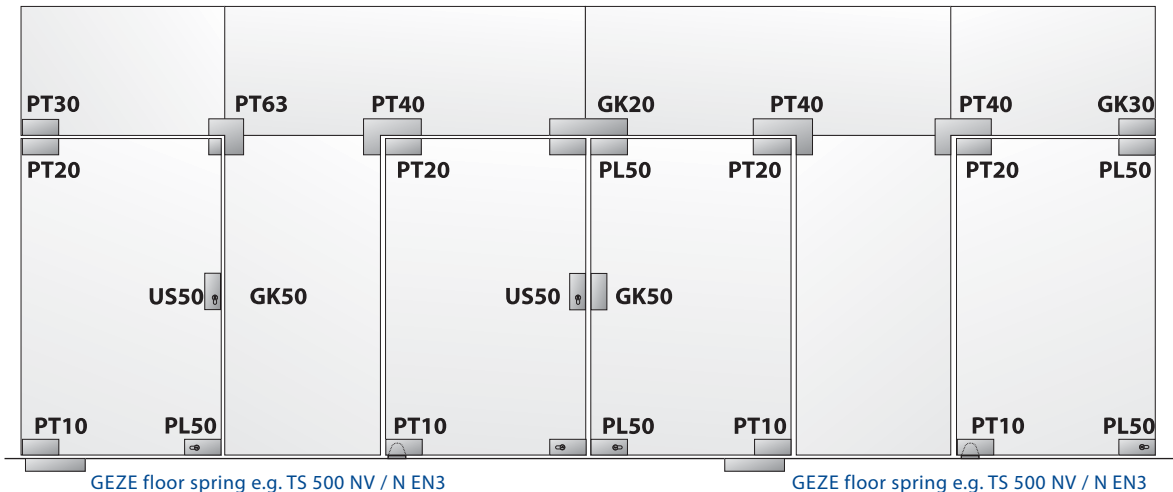

Areas of application

- ▶ For internal and external installations
- ▶ Double-action and single-action doors
- ▶ Sliding doors, manually operated and automatic
- ▶ Partition walls and wall panellings

Patch fittings characteristic

- ▶ All visible components are made of stainless steel
- ▶ Polished or satin surface finish
- ▶ 3 mm thickness of lock plate
- ▶ For toughened safety glass 10 mm and 12 mm thick and laminated glass in appropriate glass thickness

GEZE PT 10

- ▶ Lower door rail (connection to floor spring)
- ▶ For rebated swing doors and double-action doors (suitably respective application)
- ▶ Surface made of stainless steel, polished or satin

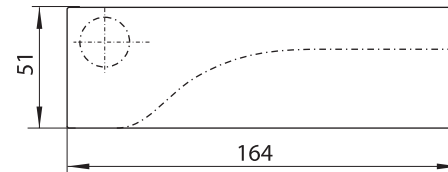
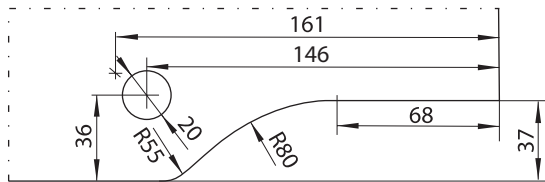
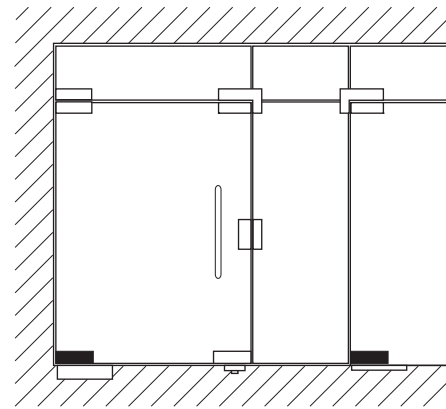

Glass cutout

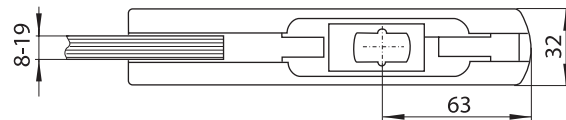

GEZE PT 20

- ▶ Upper patch fitting (pivot point)
- ▶ For rebated swing doors and double-action doors (suitably respective application)
- ▶ Surface made of stainless steel, polished or satin

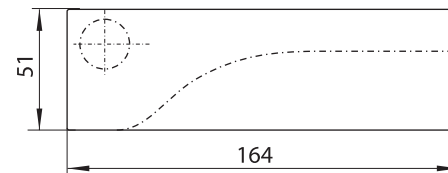
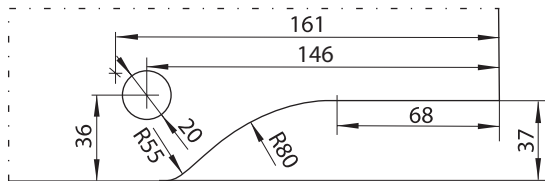
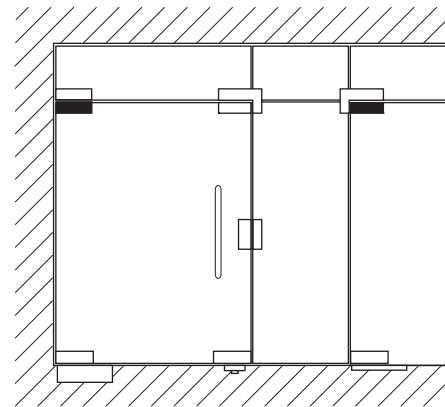

Glass cutout

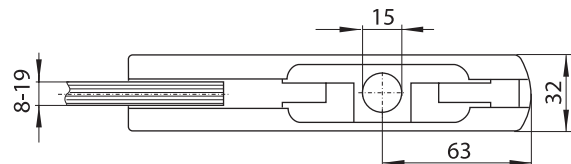

GEZE PT 30

- ▶ Upper pivot point
- ▶ For rebated swing doors and double-action doors (suitably respective application)
- ▶ Surface made of stainless steel, polished or satin

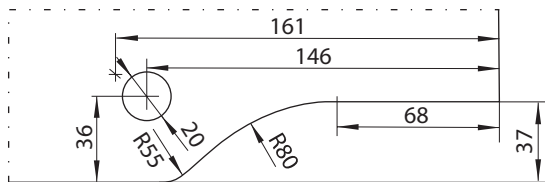
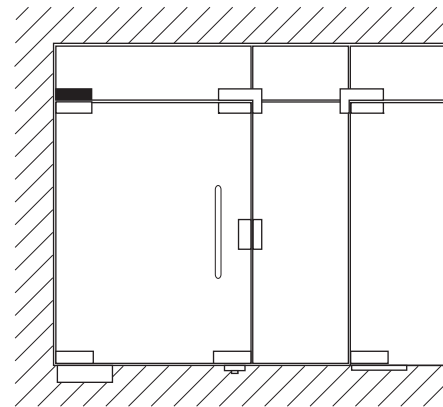

Glass cutout

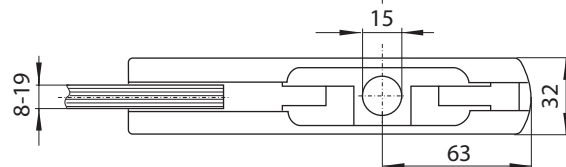
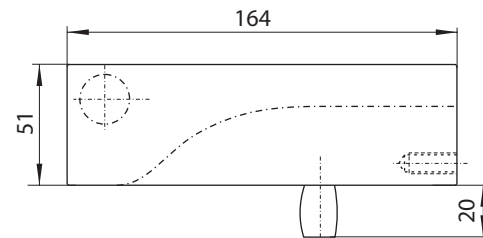

GEZE PT 24

- ▶ Upper pivot plate (if no fanlight is installed)
- ▶ For rebated swing doors and double-action doors (suitably respective application)
- ▶ Surface made of stainless steel

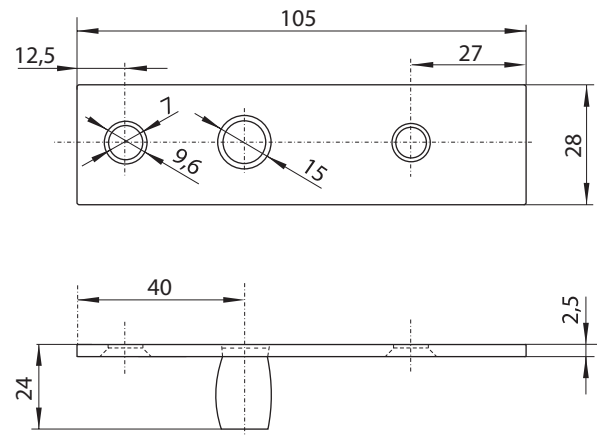
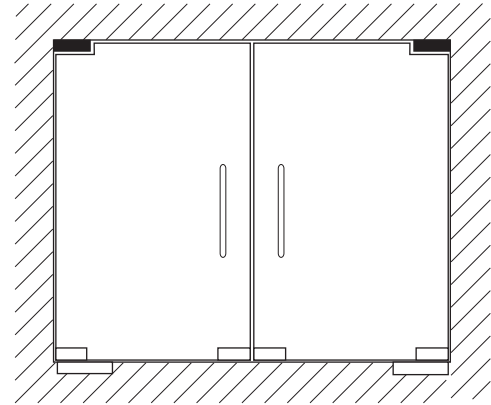

GEZE PT 40

- ▶ Upper pivot patch, connector to the fanlight as well as to the fixed side panel
- ▶ For rebated swing doors and double-action doors (suitably respective application)
- ▶ Surface made of stainless steel, polished or satin

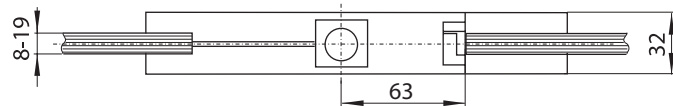
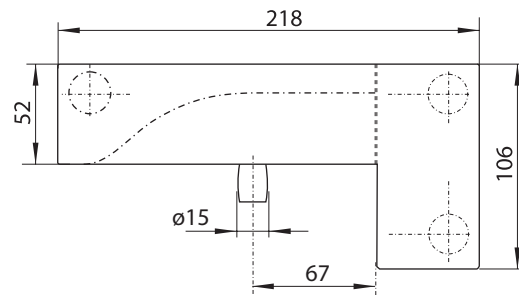
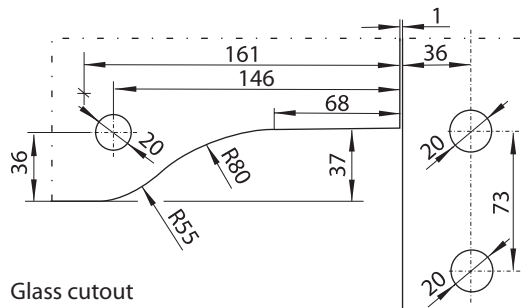
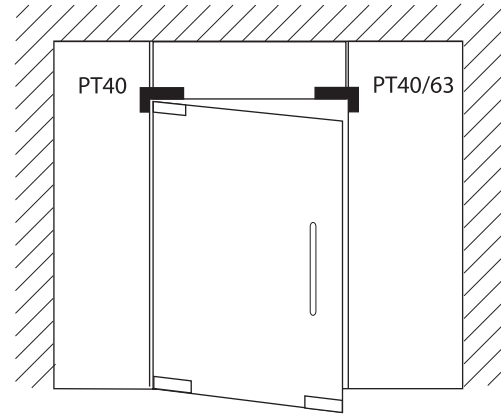

GEZE GK 50

- ▶ Counter box for center lock
- ▶ Surface made of stainless steel, polished or satin

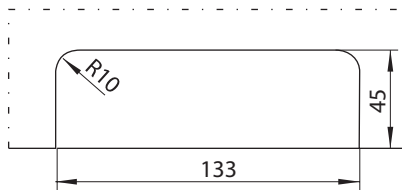
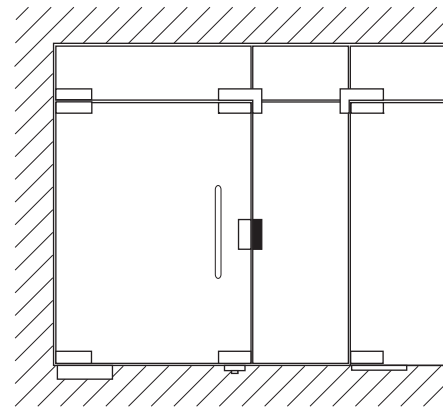

Glass cutout

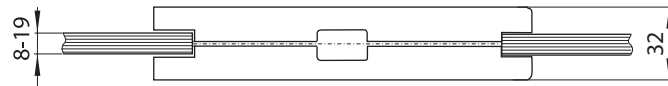
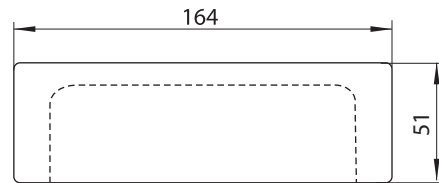

GEZE US 50

- ▶ Center lock
- ▶ Without cylinder (option: cylinder PM88)
- ▶ Surface made of stainless steel, polished or satin

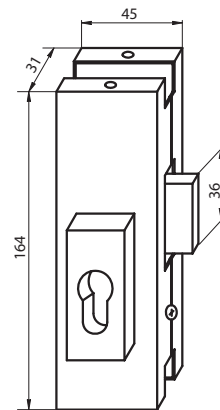
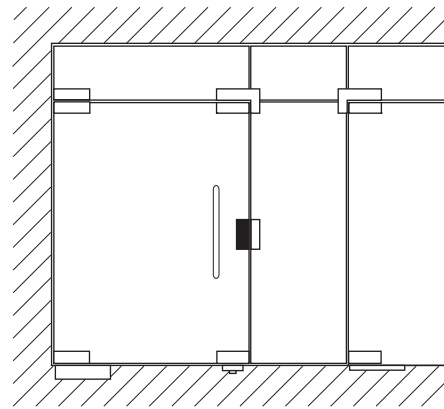

Glass cutout

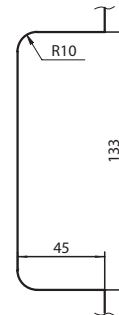

GEZE PL 50

- ▶ Corner lock, applicable on the floor or at the fanlight
- ▶ Without cylinder (option: cylinder PM88)
- ▶ Surface made of stainless steel, polished or satin

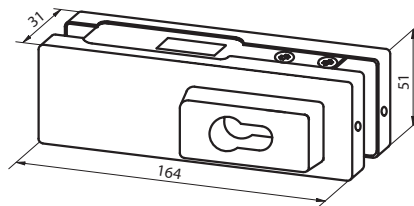
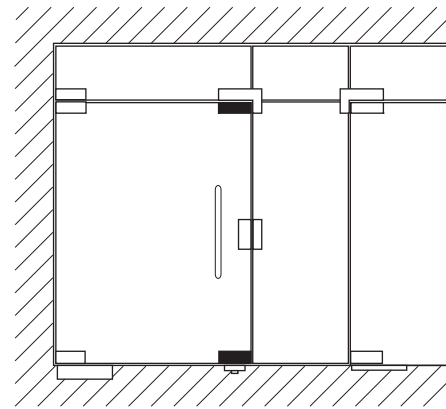

Glass cutout

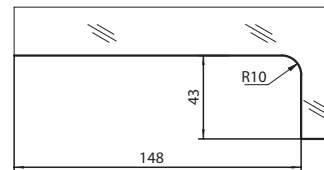

GEZE GK 20

- ▶ Counter box for double-leaf doors with two corner locks PL 50
- ▶ Surface made of stainless steel, polished or satin

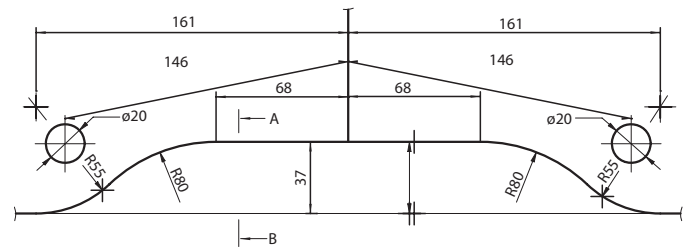
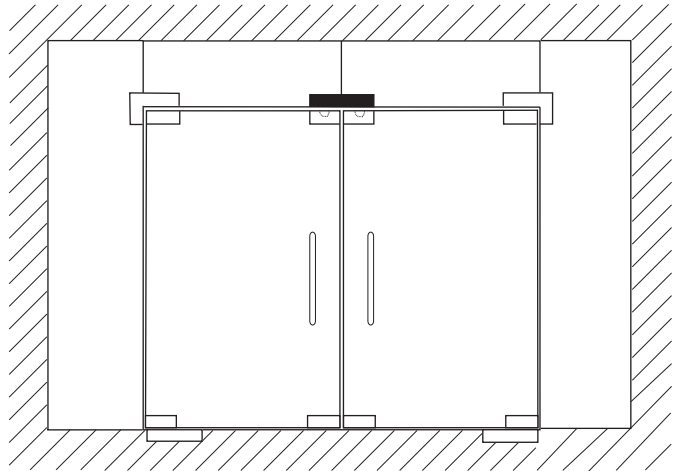
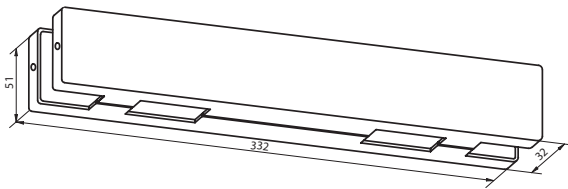

Glass cutout

GEZE PT 63

- ▶ Edge patch fitting for connection of fanlight and fixed side panel
- ▶ Surface made of stainless steel, polished or satin

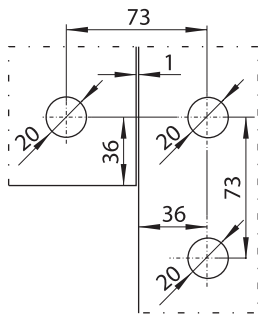
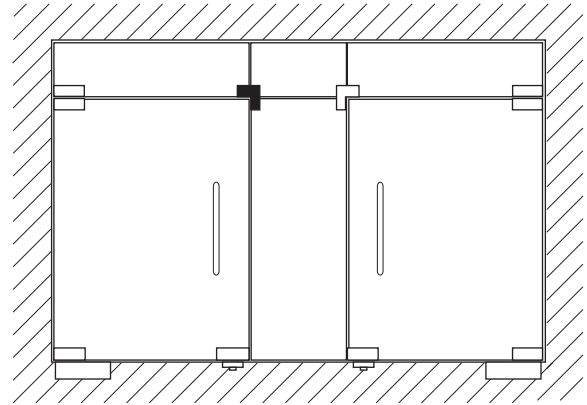

Glass cutout

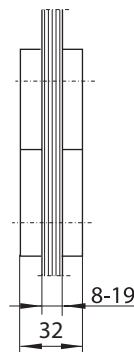
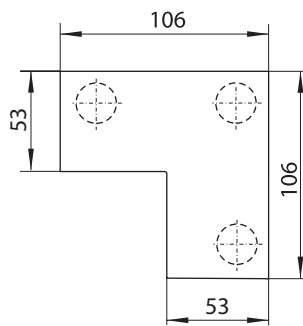

GEZE PT 80

- ▶ Fitting element for the connection of 4 panels
- ▶ Surface made of stainless steel, polished or satin

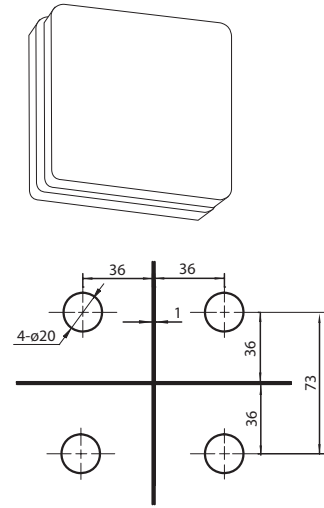

Glass cutout

GEZE PT 70

- ▶ Fitting element for the connection of 2 panels
- ▶ Surface made of stainless steel, polished or satin

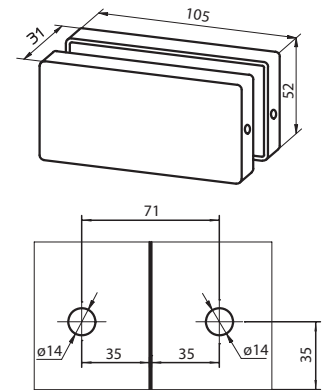

Glass cutout

Product information

Product	Description	Finish	ID No.	
GEZE PT 10	Lower door shoe (mounting on floor)	stainless steel	polished	119869
			satin	111458
GEZE PT 20	Upper fitting element (pivot point)	stainless steel	polished	119870
			satin	111459
GEZE PT 24	Upper pivot plate (if no fanlight is installed)	stainless steel		111460
GEZE PT 30	Upper pivot point (if a fanlight is installed)	stainless steel	polished	119881
			satin	111461
GEZE PT 40	Upper pivot patch, with connection to the fanlight and to the lateral fixed panel	stainless steel	polished	119882
			satin	111462
GEZE GK 50	Counter box for lock	stainless steel	polished	119883
			satin	111463
GEZE US 50	Center lock (without cylinder)	stainless steel	polished	119884
			satin	111464
GEZE PL 50	Corner lock (without cylinder) applicable on the floor or at the fanlight	stainless steel	polished	119885
			satin	111465
GEZE GK 20	Counter box for double-leaf doors with two locks	stainless steel	polished	119886
			satin	111467
GEZE PT 63	Corner transmission fixed panel to fanlight	stainless steel	polished	119887
			satin	111469
GEZE PT 70	Connector fixed panel to fanlight	stainless steel	polished	119889
			satin	111471
GEZE PT 80	Connector fanlight to fanlight	stainless steel	polished	119891
			satin	111473

For special combinations (kits together with floor springs) ask your GEZE representative.



GEZE GmbH
P.O. Box 1363
71226 Leonberg
Germany

GEZE GmbH
Reinhold-Vöster-Straße 21-29
71229 Leonberg
Germany
Telefon +49 (0) 7152-203-0
Telefax +49 (0) 7152-203-310

GEZE Online:
www.geze.com

GEZE branch offices

Germany

GEZE GmbH
Niederlassung Nord/Ost
Bührlingstraße 8
13086 Berlin (Weissensee)
Tel. +49 (0) 30-47 89 90-0
Fax +49 (0) 30-47 89 90-17
E-mail: berlin.de@geze.com

GEZE GmbH
Niederlassung West
Nordsternstraße 65
45329 Essen
Tel. +49 (0) 201-83082-0
Fax +49 (0) 201-83082-20
E-mail: essen.de@geze.com

GEZE GmbH
Niederlassung Mitte
Adenauerallee 2
61440 Oberursel (b. Frankfurt)
Tel. +49 (0) 6171-63610-0
Fax +49 (0) 6171-63610-1
E-mail: frankfurt.de@geze.com

GEZE GmbH
Niederlassung Süd
Reinhold-Vöster-Straße 21-29
71229 Leonberg
Tel. +49 (0) 7152-203-594
Fax +49 (0) 7152-203-438
E-mail: leonberg.de@geze.com

GEZE subsidiaries

Germany

GEZE Sonderkonstruktionen GmbH
Planken 1
97944 Boxberg-Schweigern
Tel. +49 (0) 7930-9294-0
Fax +49 (0) 7930-9294-10
E-mail: sk.de@geze.com

GEZE Service GmbH
Reinhold-Vöster-Straße 25
71229 Leonberg
Tel. +49 (0) 7152-9233-0
Fax +49 (0) 7152-9233-60
E-mail: info@geze-service.com

GEZE Service GmbH
Niederlassung Berlin
Bührlingstraße 8
13086 Berlin (Weissensee)
Tel. +49 (0) 30-470217-30
Fax +49 (0) 30-470217-33

**Europe
Benelux**

GEZE Benelux B.V.
Leemkuil 1
Industrieterrein Kapelbeemd
5626 EA Eindhoven
Tel. +31 (0) 40-26290-80
Fax +31 (0) 40-26290-85
E-mail: benelux.nl@geze.com

France

GEZE France S.A.R.L.
ZAC de l'Orme Rond
RN 19
77170 Servon
Tel. +33 (0) 1-60626070
Fax +33 (0) 1-60626071
E-mail: france.fr@geze.com

Great Britain

GEZE UK Ltd.
Blenheim Way
Fradley Park
Lichfield
Staffordshire WS13 8SY
Tel. +44 (0) 1543-443000
Fax +44 (0) 1543-443001
E-mail: info@geze-uk.com

Italy

GEZE Italia Srl
Via Giotto 4
20040 Cambiagio (MI)
Tel. +39 02 95 06 95-11
Fax +39 02 95 06 95-33
E-Mail italia.it@geze.it

GEZE Engineering Roma Srl
Via Lucrezia Romana 91
00178 Roma
Tel. +39 06-7265311
Fax +39 06-72653136
E-mail: gezeroma@libero.it

GEZE Engineering Bari Srl
Via Treviso 58
70022 Altamura (Bari)
Tel. +39 080-3115219
Fax +39 080-3164561
E-mail: gezebari@libero.it

Austria

GEZE Austria GmbH
Mayrwiesstraße 12
5300 Hallwang b. Salzburg
Tel. +43 (0) 662-663142
Fax +43 (0) 662-663142-15
E-mail: austria.at@geze.com

Poland

GEZE Polska Sp. z o.o.
ul. Annopol 3 (Zeran Park)
03-236 Warszawa
Tel. +48 (0) 22-8142211
Fax +48 (0) 22-6142540
E-mail: geze@geze.pl

Switzerland

GEZE Schweiz AG
Bodenackerstrasse 79
4657 Dulliken
Tel. +41 (0) 62-285 54 00
Fax +41 (0) 62-285 54 01
E-mail: schweiz.ch@geze.com

Spain

GEZE Iberia S.R.L.
Pol. Ind. El Pla
C/ Comerc, 2-22, Nave 12
08980 Sant Feliu de Llobregat
(Barcelona)
Tel. +34-(0) 9-02 19 40 36
Fax +34-(0) 9-02 19 40 35
E-mail: iberia.es@geze.com

**Scandinavia
Sweden**

GEZE Scandinavia AB
Mällslingan 10
Box 7060
18711 Täby
Tel. +46 (0) 8-7323-400
Fax +46 (0) 8-7323-499
E-mail: sverige.se@geze.com

Norway

GEZE Scandinavia AB avd. Norge
Postboks 63
2081 Eidsvoll
Tel. +47 (0) 639-57200
Fax +47 (0) 639-57173
E-mail: norge.se@geze.com

Finland

GEZE Finland
Branch office of GEZE Scandinavia AB
Postbox 20
158 71 Hollola
Tel. +358 (0) 10-400 51 00
Fax +358 (0) 10-400 51 20
E-mail: finland.se@geze.com

Denmark

GEZE Danmark
Branch office of GEZE Scandinavia AB
Høje Taastrup Boulevard 53
DK-2630 Taastrup
Tel. +45 46 32 33 24
Fax +45 46 32 33 26
E-mail: danmark.se@geze.com

**Middle East
U.A.E.**

GEZE Middle East
P.O. Box 17903
Jebel Ali Free Zone
Dubai
Tel. +971 (0) 4-8833112
Fax +971 (0) 4-8833240
E-mail: geze@emirates.net.ae

Asia

GEZE Industries (Tianjin) Co., Ltd.
Shuangchenzhong Road
Beichen Economic Development
Area (BEDA)
Tianjin 300400, P.R. China
Tel. +86 (0) 22-26973995-0
Fax +86 (0) 22-26972702
E-mail: geze@public1.tpt.tj.cn

GEZE Industries (Tianjin) Co., Ltd.
Branch Office Shanghai
Rm. 3010 Building No. 2
3 Hongqiao Road
200030 Shanghai, P.R. China
Tel. +86-(0)21-52 34 09-60/-61
Fax +86-(0)21-64 47 20 07
E-mail: gezesh@geze.com.cn

GEZE Industries (Tianjin) Co., Ltd.
Branch Office Guangzhou
Room 1113, Jie Tai Plaza
218-222 Zhong Shan Liu Road
510180 Guangzhou
P.R. China
Tel. +86 (0) 20-813207-02
Fax +86 (0) 20-813207-05
E-mail: gezegz@public2.sta.net.cn

GEZE Industries (Tianjin) Co., Ltd.
Branch Office Beijing
No. 6-32 Building, Jili Avenue
Daxing District
Chaoyang District
Tel. +86-(0)10-87 97 51-77/-78
Fax +86-(0)10-87 97 51-71
E-mail: gezebj@geze.com.cn

GEZE Asia Sales Ltd.
No. 88-1-408, East Road
Free Trade Zone of Tianjin Port
Tianjin, P.R. China
Tel. +86 (0)22-26 97 39 95-0
Fax +86 (0)22 26 97 27 02
E-mail: geze@public1.tpt.tj.cn

GEZE Sonderkonstruktionen (Tianjin)
Ltd.
No. 6-32 Building, Jili Avenue
Daxing District
Chaoyang District
100076 Beijing, P.R. China
Tel. +86 (0) 10-87 96 51-52
Fax +86 (0) 10-87 97 14-76

GEZE Representative