

About this product

Weber.sys Waterproof-it Shower is an under-tile tanking system for the waterproofing of shower cubicles prior to the fixing of ceramic, porcelain or natural stone tiles.

The system consists of Waterproof-it Compound, Waterproof-it Emulsion and Waterproof-it Membrane.

Technical services

Weber has a team of experienced advisors available to provide technical support.

Technical helpline : 0860 27 28 29 or visit www.weber-tylon.co.za

Use

Waterproof-it Shower is suitable for the waterproofing of shower cubicles prior to the fixing of ceramic, porcelain or natural stone tiles. Suitable for interior and exterior use.

System Components

The following materials are included in the drum :

2 x 5kg bags of Waterproof-it Compound (labelled Part A)

5 litre Waterproof-it Emulsion (labelled Part B)

1 roll of Waterproof-it Membrane (labelled Part C)

Tools

The following tools and accessories will be required :

Builders block-brush

Overall

Rubber gloves

Coverage

Depending on the nature and evenness of the surface and method of application, Part A mixed with Part B will cover approximately 10m² when applied as per the application instructions below.

Packaging

Product name	Packaging	Weight	Coverage
Waterproof-it Compound (Part A)	2 x 5kg bags	10kg	10m ²
Waterproof-it Emulsion (Part B)	5 litre plastic bottle	5kg	
Waterproof-it Membrane (Part C)	200mm wide x 10m length	30g/m ²	10Lm per roll

Storage and shelf life

When stored, unopened in a dry place at temperatures above 5°C, the shelf life is 12 months from date of manufacture.

Surface preparation

The following minimum curing periods should be observed before application commences :

- New concrete floors : 28 days
- New screeds : 28 days
- New brick walls : 28 days
- New cement plaster : 28 days

The walls or floors to be tiled must be wood-floated and not steel-trowelled or power-floated.

Ensure that all surfaces are clean, dry, sound and free from dust, grease or any contamination that could impair bonding.

Make good any unsound areas and remove flaky or peeling layers before tiling.

Organic growth must be removed and the spores killed using household bleach.

Application

Cement surfaces

Ensure that the substrate is clean and dust-free.

- Apply a 1.5 to 2mm thick coat of the Part A/B slurry to all corners of the shower cubicle using a block-brush or 150mm paintbrush. Allow returns of at least 100mm to accommodate the bedding of Part C.
- Apply Part C onto the wet slurry and press down firmly. Allow the membrane joints to overlap by 100mm with neighbouring membrane. Brush out any air pockets.
- Immediately apply a second coat of slurry, ensuring that Part C is completely saturated.
- Now apply a 1.5 to 2mm thick coat of the Part A/B slurry to the rest of the walls and floors of the shower cubicle. Ensure that they are well coated with no visible background showing through.
- Allow to dry for 24 hours before tiling commences.

See the Weber product guide for applicable adhesives and grouts.

Please note :

Do not use this waterproofing system as the final finish.

Features and benefits

- Exceptional and consistent quality
- Can be used on a wide range of surfaces
- 24 hour setting time

Suitable surfaces

Suitable for use on surfaces like :

- Cement-based plaster
- Cement screeds
- Concrete surfaces
- Gypsum Board
- Cement fibre board

Safety instructions

Waterproof-it Compound contains cement, which is alkaline when wet and can cause skin irritation. Use eye protection and gloves and avoid prolonged skin contact. Avoid inhalation of dust. Wash skin contamination away with warm soapy water. Remove splashes to the eyes by prolonged irrigation and consult a doctor. Do not ingest.

Guarantee

Totally committed to quality, customer service and the ongoing development of high performance tile fixing products, Weber is proud to provide a ten year guarantee in support of its products in use.

This guarantee covers Weber products used in any type of installation as long as they have been applied in accordance with the company's specification and instructions.

Reliable and trouble-free installations depend on quality products applied following good working practice. Installations so applied and used within their design parameters have the full backing of the Weber guarantee for 10 years.

Limitations

Not suitable as a final finish or for use in direct sunlight.

Not suitable for waterproofing exterior building walls, industrial floors or unstable surfaces.

Not suitable for tanking areas that are continually immersed, such as ponds and pools.

Not suitable for waterproofing roofs and terraces.

Not resistant to pressure washing on some substrates.

Masking

Mask all areas where there is a risk of splashing and staining and where straight edges are required.

Masking tape must be removed before the material has dried.

Mixing

- Combine the two 5kg bags of Part A with Part B and mix to a creamy slurry.
- Allow the mixture to mature for 5 minutes and re-mix thoroughly.
- Do not add any water to the mixture.

Drywall

Ensure that the substrate is clean and dust-free.

- Apply a 1.5 to 2mm thick coat of the Part A/B slurry to all corners of the shower cubicle using a block-brush or 150mm paintbrush. Allow returns of at least 100mm to accommodate the bedding of Part C.
- Apply Part C onto the wet slurry and press down firmly. Allow the membrane joints to overlap by 100mm with neighbouring membrane. Brush out any air pockets.
- Immediately apply a second coat of slurry, ensuring that Part C is completely saturated.
- Now apply a 1.5 to 2mm thick coat of the Part A/B slurry to the rest of the walls and floors of the shower cubicle. Ensure that they are well coated with no visible background showing through.
- Allow to dry for 24 hours before tiling commences. See the Weber product guide for applicable adhesives and grouts.

Please note : Do not use this waterproofing system as the final finish.



Cut membrane to size, allowing the joints to overlap by 100mm with neighbouring membrane.



Combine the two bags of Part A with Part B and mix to a creamy slurry. Allow the mixture to mature for 5 minutes. Do not add more water.



Apply a 1.5 to 2mm thick coat of the Part A/B slurry to all corners of the shower cubicle using a block-brush. Allow returns of at least 100mm to accommodate the bedding of part C.



Apply Part C onto the wet slurry and press down firmly. Allow the membrane joints to overlap by 100mm with neighbouring membrane. Brush out any air pockets. Immediately apply a second coat of slurry, ensuring that Part C is completely saturated.



Apply a 1.5 to 2mm thick coat of the Part A/B slurry to the rest of the walls and floor of the shower cubicle. Ensure that they are well coated with no visible background showing through. Allow to dry for 24 hours before tiling commences.

MASONRY SHOWER DETAIL

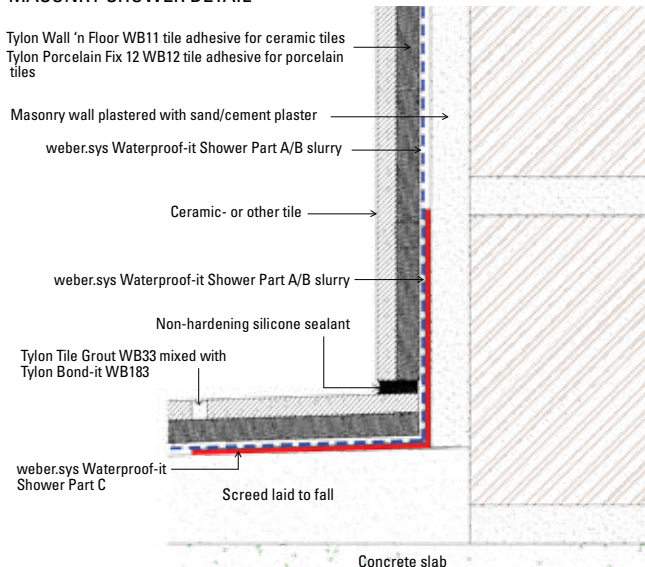

DRYWALL SHOWER DETAIL

